

**TECHNICAL MANUAL**

**ORGANIZATIONAL, DIRECT SUPPORT, AND GENERAL SUPPORT MAINTENANCE  
REPAIR PARTS AND SPECIAL TOOLS LISTS  
(INCLUDING DEPOT MAINTENANCE REPAIR PARTS AND SPECIAL TOOLS)  
FOR  
SIGNAL GENERATOR ANIURM-170  
(NSN 6625-00-883-3256)**

---

**HEADQUARTERS, DEPARTMENT OF THE ARMY**

**AUGUST 1977**

TECHNICAL MANUAL }  
 No. 11-6625-2520-24P }

HEADQUARTERS  
 DEPARTMENT OF THE ARMY  
 WASHINGTON, DC, 29 August 1977

ORGANIZATIONAL, DIRECT SUPPORT, AND GENERAL SUPPORT MAINTENANCE  
 REPAIR PARTS AND SPECIAL TOOLS LISTS  
 (INCLUDING DEPOT MAINTENANCE REPAIR PARTS AND SPECIAL TOOLS)  
 FOR  
 SIGNAL GENERATOR AN/URM-170  
 (NSN 6625-00-883-3256)  
 Current as of 13 June 1977

**REPORTING OF ERRORS**

You can improve this manual by recommending improvements using DA Form 2028-2 (Test) located in the back of the manual. Simply tear out the self-addressed form, fill it out as shown on the sample, fold it where shown, and drop it in the mail.

If there are no blank DA Forms 2028-2 (Test) in the back of your manual, use the standard DA Form 2028 (Recommended Changes to Publications and Blank Forms) and forward to the Commander, US Army Electronics Command, ATTN: DRSELMA-Q, Fort Monmouth, NJ 07703.

In either case, a reply will be furnished direct to you.

**Table of Contents**

		Page	Illus Figure
SECTION	I. Introduction .....	1	
	II. Repair parts list .....	5	
GROUP	00 Signal Generator AN/URM-170 .....	6	1
	01 Signal Generator SG-756/URM .....	7	2-6
	0101 Pulser assembly (A1) .....	17	7
	010101 Cable assemblies, radio frequency (A1WI) thru (A1W4) .....	21	8
	010102 Switch assembly, rotary (A1A1) .....	23	9
	010103 Circuit card assembly (A1A900) .....	27	10
	010104 Circuit card assembly (A1A1000) .....	31	11
	0102 Front panel assembly .....	33	12-14
	010201 Drive assembly (A2A1) .....	39	15
	010202 Probe assembly (A2A2) .....	41	16
	010203 Probe assembly (A2A3) .....	43	17
	010204 Frequency control assembly (A2A4) .....	45	18
	010205 Divider assembly (A2A5) .....	49	19
	010206 Wiring harness (A2W1) .....	51	20
	01020601 Resistor board assembly (A2W1A1) .....	53	21
	010207 Circuit card assembly (A300) .....	65	22
	010208 Circuit card assembly (A400) .....	57	23
	010209 Circuit card assembly (A500) .....	59	24
	010210 Circuit card assembly (A600) .....	61	25
	010211 Circuit card assembly (A700) .....	63	26
SECTION	III. Special tools list (Not applicable)		
	IV. National stock number and part number index .....	64	

\* This manual supersedes so much of TM 116625-2520-14, 12 June 1972, including Change 1, 28 August 1974, as pertains to repair parts and special tools list.

**SECTION I  
INTRODUCTION**

**1. Scope**

This manual lists spares and repair parts; special tools; special test, measurement, and diagnostic equipment (TMDE), and other special support equipment required for performance of organizational, direct support, and general support maintenance of the AN/URM-170. It authorizes the requisitioning and issue of spares and repair parts as indicated by the source and maintenance codes.

**2. General**

This Repair Parts and Special Tools List is divided into the following sections:

*a. Section II. Repair Parts List.* A list of spares and repair parts authorized for use in the performance of maintenance. The list also includes parts which must be removed for replacement of the authorized parts. Parts lists are composed of functional groups in numeric sequence, with the parts in each group listed in figure and item number sequence.

*b. Section III. Special Tools List.* Not applicable.

*c. Section IV. National Stock Number and Part Number Index.* A list, in National item identification number (NIIN) sequence, of all National stock numbers (NSN) appearing in the listings, followed by a list, in alphameric sequence, of all part numbers appearing in the listings. National stock numbers and part numbers are cross referenced to each illustration figure and item number appearance.

**3. Explanation of Columns**

*a. Illustration.* This column is divided as follows:

*(1) Figure number.* Indicates the figure number of the illustration on which the item is shown

*(2) Item number.* The number used to identify item called out in the illustration.

*b. Source, Maintenance, and Recoverability (SMR) Codes.*

*(1) Source code.* Source codes indicate the manner of acquiring support items for maintenance, repair, or overhaul of end items. Source

codes are entered in the first and second positions of the Uniform SMR Code format as follows:

<i>Code</i>	<i>Definition</i>
PA-	Item procured and stocked for anticipated or known usage.
XD-	A support item that is not stocked. When required, item will be procured through normal supply channels.

**NOTE**

Cannibalization or salvage may be used as a source of supply for any items source coded above except those coded XA and aircraft support items as restricted by AR 700-42.

*(2) Maintenance code.* Maintenance codes are assigned to indicate the levels of maintenance authorized to USE and REPAIR support items. The maintenance codes are entered in the third and fourth positions of the Uniform SMR Code format as follows:

(a) The maintenance code entered in the third position will indicate the lowest maintenance level authorized to remove, replace, and use the support item. The maintenance code entered in the third position will indicate one of the following levels of maintenance:

<i>Code</i>	<i>Application/Explanation</i>
O	-Support item is removed, replaced, used at the organizational level.
H	-Support item is removed, replaced, used at the general support level.

(b) The maintenance code entered in the fourth position indicates whether the item is to be repaired and identifies the lowest maintenance level with the capability to perform complete repair (i.e., all authorized maintenance functions). This position will contain one of the following maintenance codes:

<i>Code</i>	<i>Application/Explanation</i>
H	-The lowest maintenance level capable of complete repair of the support item is the general support level.
-	-Nonreparable. No repair is authorized.

(3) *Recoverability code.* Recoverability codes are assigned to support items to indicate the disposition action on unserviceable items. The recoverability code is entered in the fifth position of the Uniform SMR Code format as follows:

*Recoverability*

<i>Codes</i>	<i>Definition</i>
Z -Nonreparable item.	When unserviceable, condemn and dispose at the level indicated in position 3.
H -Reparable item.	When uneconomically reparable, condemn and dispose at the general support level.

H -Reparable item. When uneconomically reparable, condemn and dispose at the general support level.

*c. National Stock Number.* Indicates the National stock number assigned to the item and will be used for requisitioning purposes.

*d. Part Number.* Indicates the primary number used by the manufacturer (individual, company, firm, corporation, or Government activity), which controls the design and characteristics of the item by means of its engineering drawings, specifications, standards, and inspection requirements to identify an item or range of items.

**NOTE**

When a stock-numbered item is requisitioned, the repair part received may have a different part number than the part being replaced

*e. Federal Supply Code for Manufacturer (FSCM).* The FSCM is a 5-digit numeric code listed in SB 708-42 which is used to identify the manufacturer, distributor, or Government agency, etc.

*f. Description.* Indicates the Federal item name and, if required, a minimum description to identify the item.

*g. Unit of Measure (U/M).* Indicates the standard of the basic quantity of the listed item as used in performing the actual maintenance function. This measure is expressed by a two-character alphabetical abbreviation (e.g., ea, in, pr, etc). When the unit of measure differs from the unit of issue, the lowest unit of issue that will satisfy

the required units of measure will be requisitioned.

*h. Quantity Incorporated in Unit.* Indicates the quantity of the item used in the breakout shown on the illustration figure, which is prepared for a functional group, subfunctional group, or an assembly.

**4. Special Information**

The following publications pertain to the AN/URM-170 and its components:  
 TM 11-66252520-14, Signal Generator AN/URM-170

**5. How to Locate Repair Parts**

a. When National stock number or part number is unknown.

(1) *First.* Using the table of contents, determine the functional group within which the item belongs. This is necessary since illustrations are prepared for functional groups and listings are divided into the same groups.

(2) *Second.* Find the illustration covering the functional group to which the item belongs.

(3) *Third.* Identify the item on the illustration and note the illustration figure and item number of the item.

(4) *Fourth.* Using the Repair Parts Listing, find the figure and item number noted on the illustration.

b. When National stock number or part number is known.

(1) *First.* Using the Index of National Stock Numbers and Part Numbers, find the pertinent National stock number or part number. This index is in NIIN sequence followed by a list of part numbers in alphameric sequence, cross-referenced to the illustration figure number and item number.

(2) *Second.* After finding the figure and item number, locate the figure and item number in the repair parts list.

**6. Abbreviations**

Not applicable.

(Next printed page is 4)

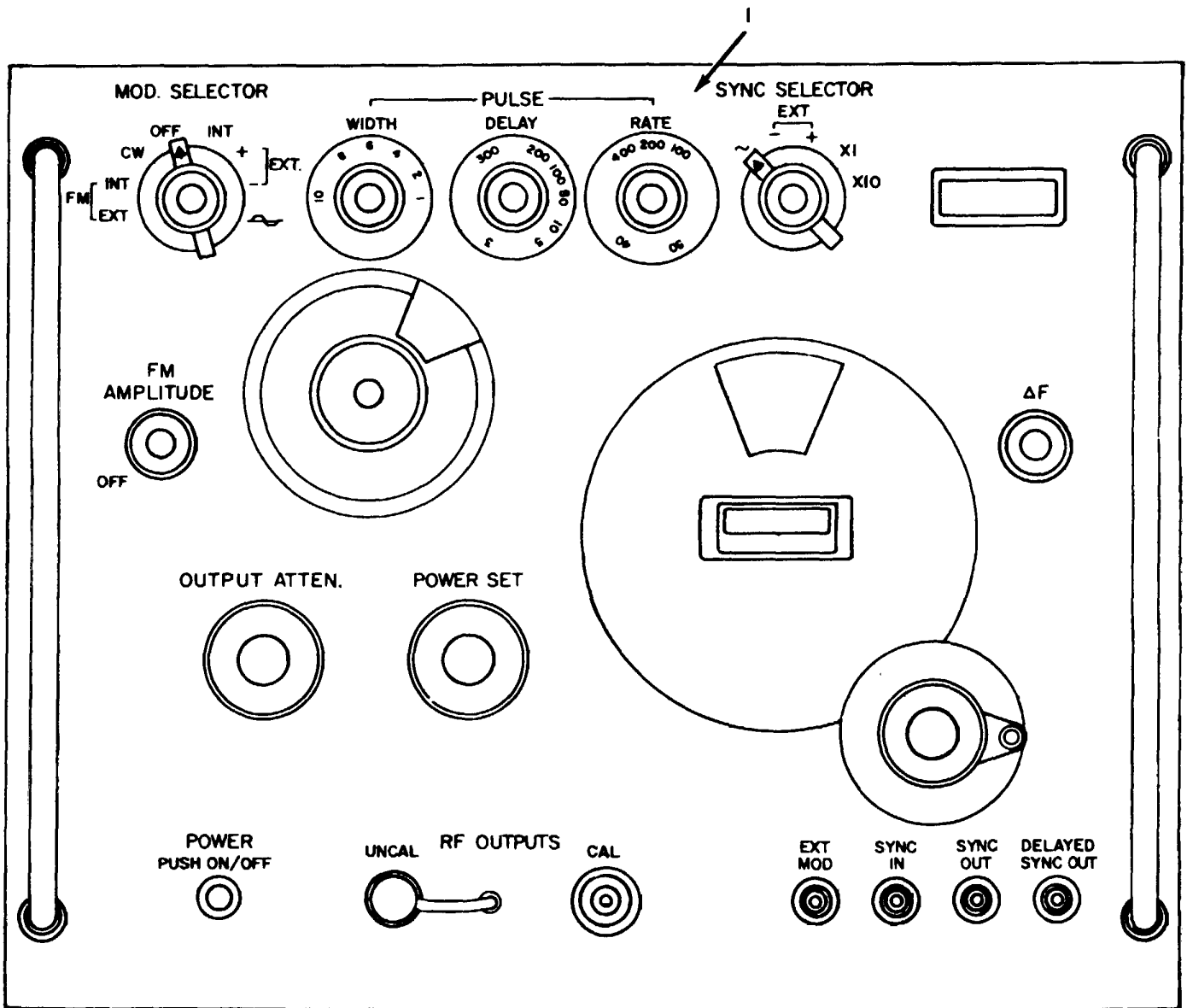

EL3GB001

Figure 1. Signal Generator AN/URM-170 .

SECTION II

TM11-6625-2520-24P

(1) ILLUSTRATION		(2)	(3)	(4)	(5)	(6)	(7)	(8)
(a) FIG NO.	(b) ITEM NO.	SMR CODE	NATIONAL STOCK NUMBER	PART NUMBER	FSCM	DESCRIPTION  USABLE ON CODE	U/M	QTY INC IN UNIT
1	1	XDOHH		SG-756/URN	80058	GROUP 00 SIGNAL GENERATOR AN/URM-170 SIGNAL GENERATOR	EA	1
					5			

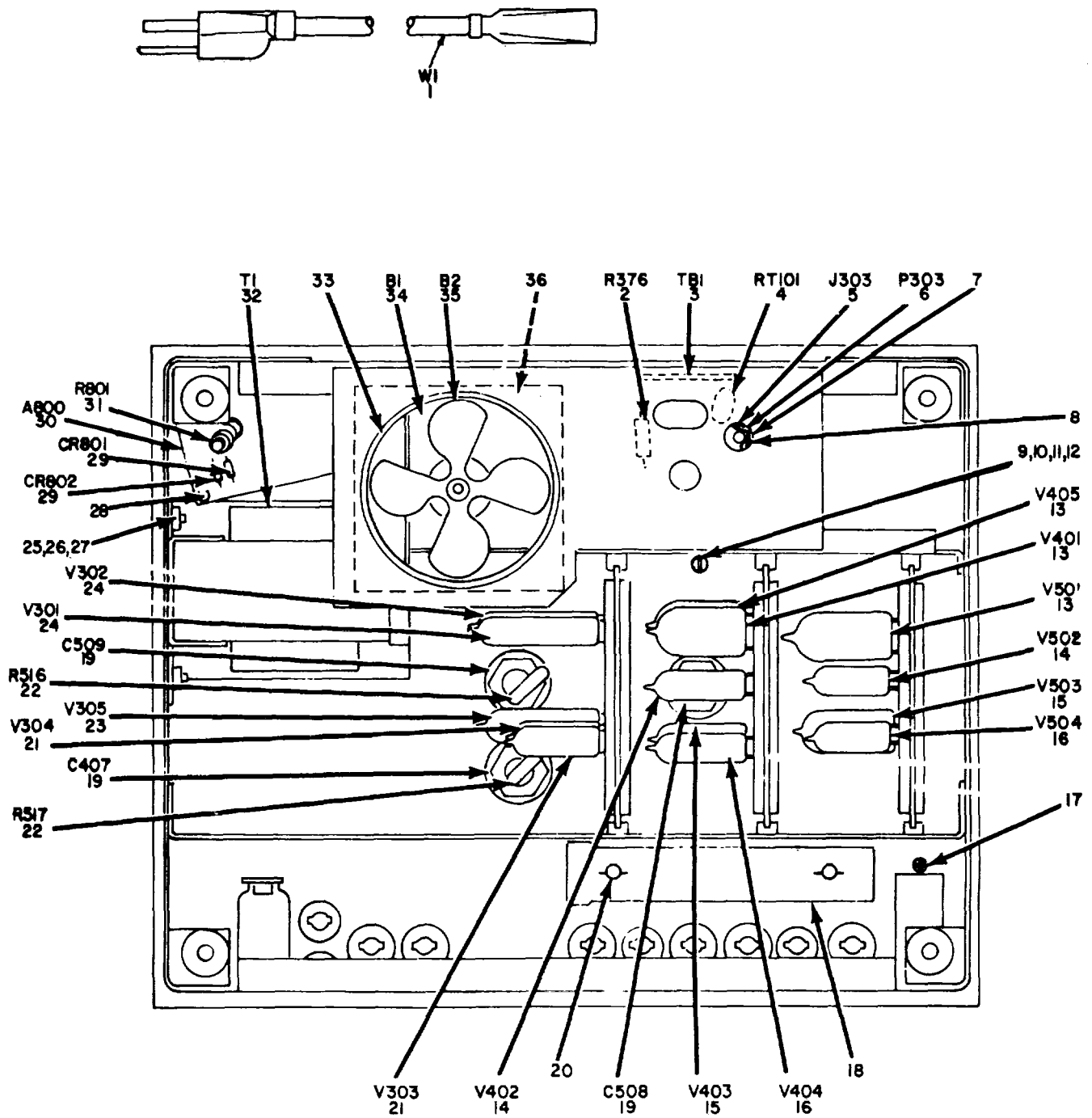

EL368002

Figure 2. Signal Generator SG-756/URM, Rear View Cover and Power Cable Removed.



## SECTION II

TM 11-6625-2520-24P

(1) ILLUSTRATION		(2)	(3)	(4)	(5)	(6)	(7)	(8)
(a) FIG NO.	(b) ITEM NO.	SMR CODE	NATIONAL STOCK NUMBER	PART NUMBER	FSCM	DESCRIPTION  USABLE ON CODE	U/M	QTY INC IN UNIT
						GROUP 01 SIGNAL GENERATOR SG-756/URM		
2	1	PAHZZ	6150-00-351-3405	CG756/URM	70903	CABLE ASSEMBLY	EA	1
2	2	PAHZZ	5905-00-982-0469	RN55C3482F	81349	RESISTOR,FXD,FILM	EA	1
2	3	PAHZZ	5940-00-105-6337	332-L4-07-183	71785	TERMINAL BOARD	EA	1
2	4	PAHZZ	5905-00-875-4363	2D754	03508	THERMISTOR	EA	1
2	5	PAHZZ	5935-00-259-2039	M7S	81312	CONNECTOR,REPT ELEC	EA	1
2	6	PAHZZ	5935-00-257-9879	M7P	81312	CONNECTOR,PLUG,ELEC	EA	1
2	7	XDHZZ		M7LS	81312	SPRING,LOCK	EA	1
2	8	PAHZZ	5935-00-113-5091	H16	81312	COVER,ELEC CONN	EA	1
2	9	PAHZZ	5310-00-934-9761	MS35649-264	96906	NUT,PLAIN,HEXAGON	EA	2
2	10	PAHZZ	5305-00-054-6662	MS51957-38	96906	SCREW,MACHINE	EA	2
2	11	PAHZZ	5310-00-880-5978	MS15795-807	96906	WASHER,FLAT	EA	2
2	12	PAHZZ	5310-00-939-0903	MS35335-86	96906	WASHER,LOCK	EA	2
2	13	PAHZZ	5960-00-269-3691	1923-0071	28480	ELECTRON TUBE	EA	3
2	14	PAHZZ	5960-00-262-086	5651A	80131	ELECTRON TUBE	EA	2
2	15	PAHZZ	5960-00-967-1083	6EJ7EF184	80131	ELECTRON TUBE	EA	2
2	16	PAHZZ	5960-00-557-6780	6C4	80131	ELECTRON TUBE	EA	2
2	17	XDHZZ		2190-0023	28480	WASHER,LOCK	EA	4
2	81	PAHZZ	5120-00-116-7985	618838	28480	WRENCH,SOCKET	EA	1
2	19	PAHZZ	5910-00-681-9264	0160-0102	28480	CAPACITOR,FXD,PPR	EA	3
2	20	XDHZZ		5020-7433	28480	THUMBSCREW	EA	4
2	21	PAHZZ	5960-00-827-8782	12AX7A	81349	ELECTRON TUBE	EA	2
2	22	XDHZZ		C32-4304J	16299	RESISTOR,FXD,FILM	EA	2
2	23	PAHZZ	5960-00-027-1728	0B2	80131	ELECTRON TUBE	EA	1
2	24	PAHZZ	5960-00-088-6527	7233	33173	ELECTRON TUBE	EA	2
2	25	XDHZZ		82100	73734	NUT,PLAIN,HEXAGON	EA	6
2	26	PAHZZ	5305-00-050-9232	MS51957-66	96906	SCREW,MACHINE	EA	4
2	27	XDHZZ		1308	73734	WASHER,LOCK	EA	6
2	28	PAHZZ	5310-00-184-8977	MS35338-98	96906	WASHER,LOCK	EA	5
2	29	PAHZZ	5961-00-060-8638	1901-0026	28480	SEMICONDUCTOR,DIODE	EA	2
2	30	PAHHH	6625-00-213-2625	00618-6075	28480	CIRCUIT CARD ASSY	EA	1
2	31	PAHZZ	5905-00-950-2798	2100-0308	28480	RESISTOR,VAR WM	EA	1
2	32	PAHZZ	5950-00-056-0131	9100-1703	28480	TRANSFORMER,POWER	EA	1
2	33	XDHZZ		00618-2048	28480	DUCT,FAN	EA	1
2	34	XDHZZ		M14L1-4R3	16228	MOTOR,ALT,CURRENT	EA	1
2	35	PAHZZ	4140-00-019-4686	0-443-4	06812	IMPELLER,FAN,AXIAL	EA	1
2	36	XDHZZ	5355-00-156-6559	1510	88245	NUT,PLAIN,HRXAGON	EA	1
					7			

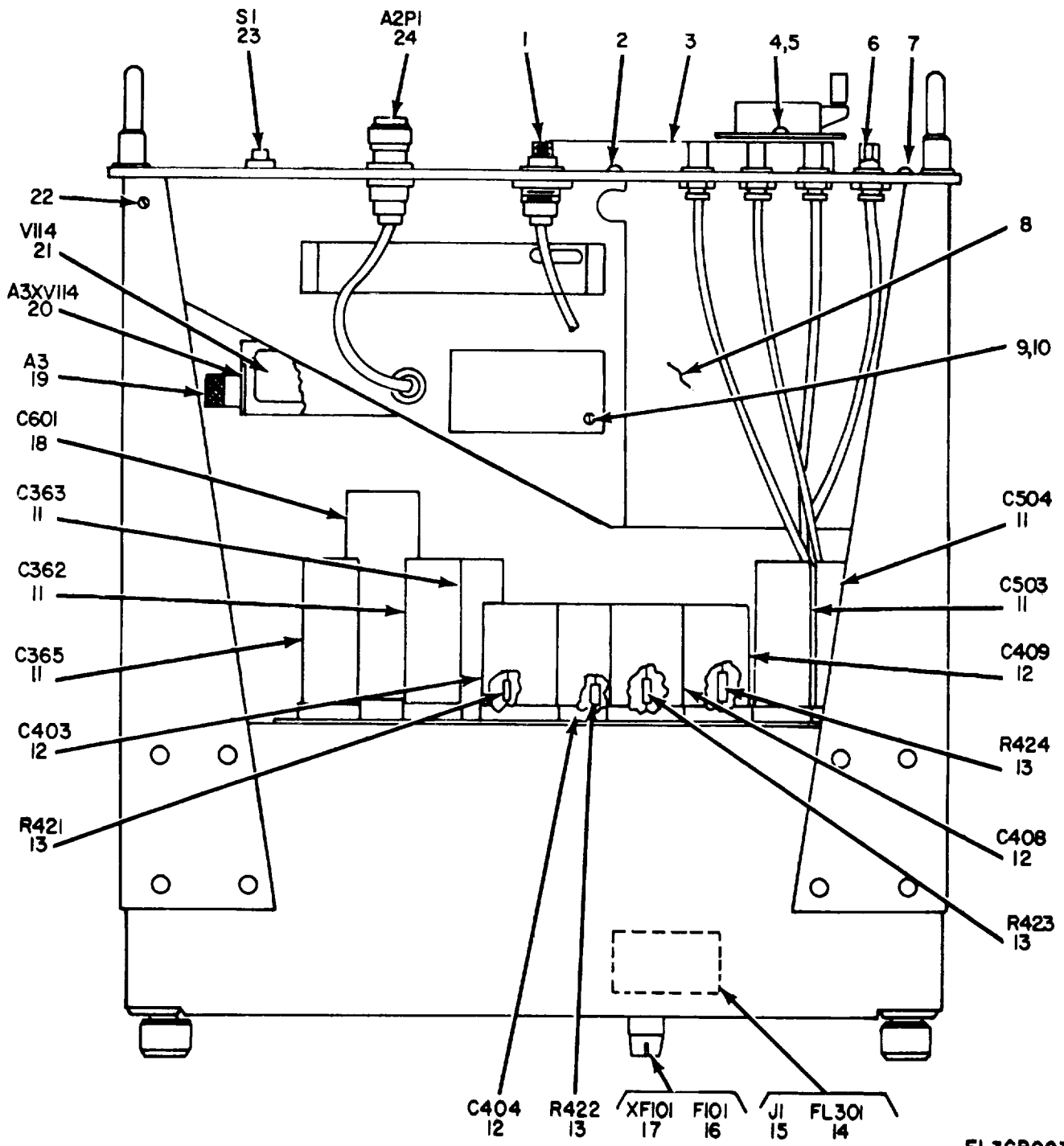

EL3GB003

Figure 3. Signal Generator SG-756/URM, Bottom View, Cover Removed.

## SECTION II

TM 11-6625-2520-24P

(1) ILLUSTRATION		(2)	(3)	(4)	(5)	(6)	(7)	(8)
(a) FIG NO.	(b) ITEM NO.	SMR CODE	NATIONAL STOCK NUMBER	PART NUMBER	FSCM	DESCRIPTION  USABLE ON CODE	U/M	QTY INC IN UNIT
3	1	PAHZZ	5935-00-931-0420	5020-0306	28480	CAP,ELECTRICAL	EA	1
3	2	XDHZZ		22028	73734	SCREW,MACHINE	EA	4
3	3	PAHZZ	5355-00-883-8579	618840A	28480	DIAL,SCALE	EA	1
3	4	PAHZZ	5305-00-054-6670	MS51957-45	96906	SCREW,MACHINE	EA	2
3	5	PAHZZ	5310-00-045-3296	MS35338-43	96906	WAASHER,LOCK	EA	2
3	6	XDHZZ		1678	02732	SPRING,HLCL,EXT	EA	2
3	7	XHDZZ		22042	73734	SCREW,MACHINE	EA	4
3	8	XDHZZ		620A36BB	28480	COVER PLATE,DR MECH	EA	1
3	9	PAHZZ	5305-00-057-0526	MS51598-30	96906	SCREW,MACHINE	EA	2
3	10	PAHZZ	5310-00-905-9862	MS35336-56	96906	WASHER,LOCK	EA	4
3	11	PAHZZ	5910-00-087-3522	0180-0024	28480	CAPACITOR,ELCTLT	EA	5
3	12	PAHZZ	5910-00-087-6816	0180-0042	28480	CAPACITOR,ELCTLT	EA	4
3	13	PAHZZ	5905-00-141-1071	RCR20G474JS	81349	RESISTOR,FXD,COMP	EA	4
3	14	PAHZZ	5915-00-421-6425	9L00-2887	28480	FILTER,LINE	EA	1
3	15	PAHZZ	5935-00-233-6728	EAC301	82389	CONNECTOR,RCPT,ELEC	EA	1
3	16	PAHZZ	5920-00-538-3494	MDX3	71400	FUSE,CARTRIDGE	EA	1
3	17	PAHZZ	5920-00-760-6324	342014	75915	FUSEHOLDER	EA	1
3	18	PAHZZ	5910-00-931-1908	0180-0128	28480	CAPACITOR,ELCTLT	EA	1
3	19	XDHHH		00618-6070	28480	SOCKET ASSEMBLY	EA	1
3	20	PAHZZ	5935-00-257-7154	78S45	02660	SOCKET,ELCTRN TUBE	EA	1
3	21	PAHZZ	5960-00-269-3726	1950-0004	28480	ELECTRON TUBE	EA	1
3	22	PAHZZ	5305-00-054-5648	MS51957-14	96906	SCREW,MACHINE	EA	3
3	23	PAHZZ	5930-00-476-9679	3101-1248	28480	SWITCH,PUSH	EA	1
3	24	PAHZZ	5935-00-920-7094	08614-227	28480	CAP,ELECTRICAL	EA	1
					<b>9</b>			

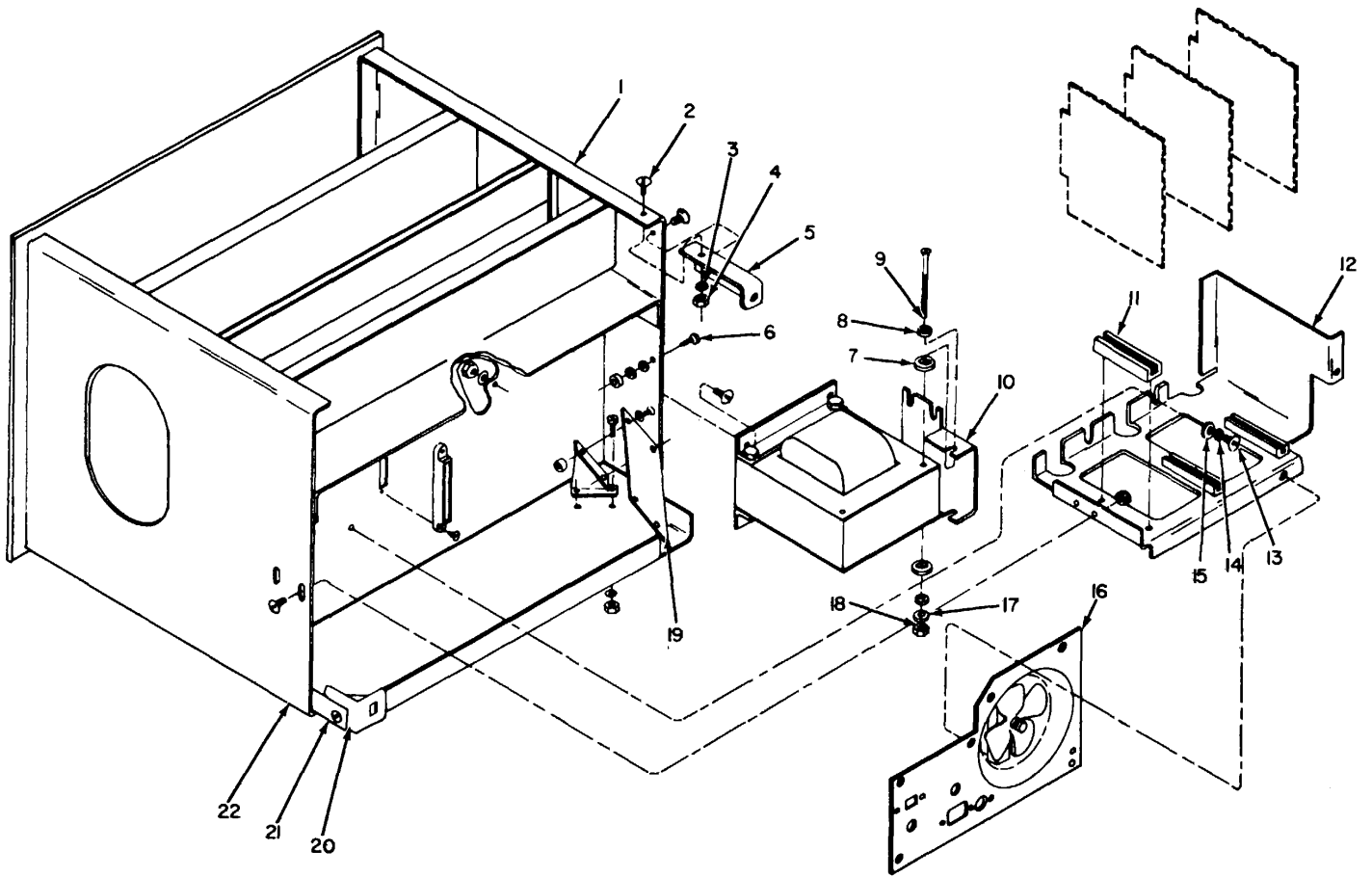

EL3GB004

Figure 4. Signal Generator SG-756/URM, Chassis, Rear View .

## SECTION II

TM 11-6625-2520-24P

(1) ILLUSTRATION		(2)	(3)	(4)	(5)	(6)	(7)	(8)
(a) FIG NO.	(b) ITEM NO.	SMR CODE	NATIONAL STOCK NUMBER	PART NUMBER	FSCM	DESCRIPTION  USABLE ON CODE	U/M	QTY INC IN UNIT
4	1	XDHZZ		00618-0053	28480	SUPPORT,BASE	EA	1
4	2	XDHZZ		11608	73734	SCREW,MACHINE	EA	2
4	3	PAHZZ	5310-00-942-5110	MS35335-88	96906	WASHER,LOCK	EA	2
4	4	PAHZZ	5310-00-934-9760	MS35649-204	96906	NUT,PLAIN,HEXAGON	EA	2
4	5	XDHZZ		00618-0056	28480	EXTENSION,SUPPORT	EA	2
4	6	XDHZZ		11608	73734	SCREW,MACHINE	EA	6
4	7	PAHZZ	5310-00-880-5978	MS15795-807	96906	WASHER,FLAT	EA	3
4	8	PAHZZ	5310-00-933-8120	MS35338-138	96906	WASHER,LOCK	EA	4
4	9	XDHZZ		12077	73734	SCREW,MACHINE	EA	1
4	10	XDHZZ		00618-030	28480	BRACKET,MOUNTING	EA	1
4	11	XDHZZ		0403-0150	28480	GUIDE,CIRCUIT CARD	EA	6
4	12	XDHZZ		00618-0050	28480	PANEL,BLANK	EA	1
4	13	PAHZZ	5305-00-057-0523	MS51958-27	96906	SCREW,MACHINE	EA	2
4	14	PAHZZ	5310-00-939-0903	MS35335-86	96906	WASHER,LOCK	EA	2
4	15	PAHZZ	5310-00-880-5978	MS15795-807	96906	WASHER,FLAT	EA	2
4	16	XDHZZ		00618-00070	28480	BRACKET,MOUNTING	EA	1
4	17	PAHZZ	5310-00-045-3296	MS35338-43	96906	WASHER,LOCK	EA	5
4	18	PAHZZ	5310-00-934-9759	MS35649-284	96906	NUT,PLAIN,HEXAGON	EA	1
4	19	XDHZZ		618812D	28480	BRACKET,MOUNTING	EA	1
4	20	XDHZZ		618812E	28480	BRACKET,MOUNTING	EA	1
4	21	XDHZZ	5355-00-156-6559	1510	88245	BUSHING,LOCK	EA	1
4	22	XDHZZ		00618-031	28480	SUPPORT,BASE	EA	1
					<b>11</b>			

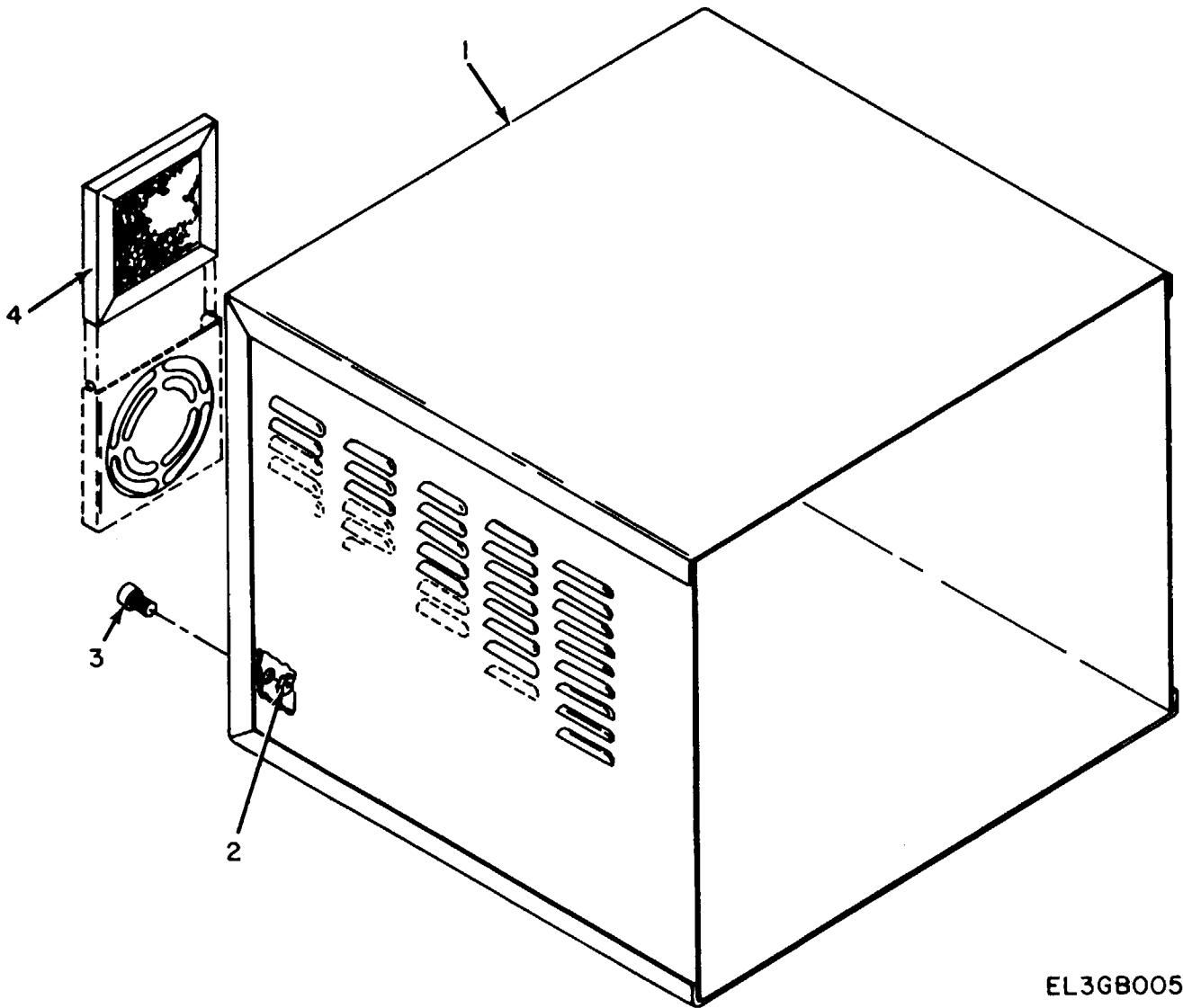

EL3GB005

Figure 5. Signal Generator SG-756/URW, Dust Cover .

SECTION II

TM 11-6625-2520-24P

(1) ILLUSTRATION		(2)	(3)	(4)	(5)	(6)	(7)	(8)
(a) FIG NO.	(b) ITEM NO.	SMR CODE	NATIONAL STOCK NUMBER	PART NUMBER	FSCM	DESCRIPTION  USABLE ON CODE	U/M	QTY INC IN UNIT
5	1	XDHZZ		00618-6056	28480	CABINET,ASSEMBLY	EA	1
5	2	PAHZZ	5310-00-934-9761	MS35649-264	96906	NUT,PLAIN,HEXAGON	EA	6
5	3	PAHZZ	5305-00-057-0524	MS51958-28	96906	SCREW,MACHINE	EA	10
5	4	PAHZZ	4130-00-821-2447	3150-0005	28480	FILTER,AIR CONDTRN	EA	1
					<b>13</b>			

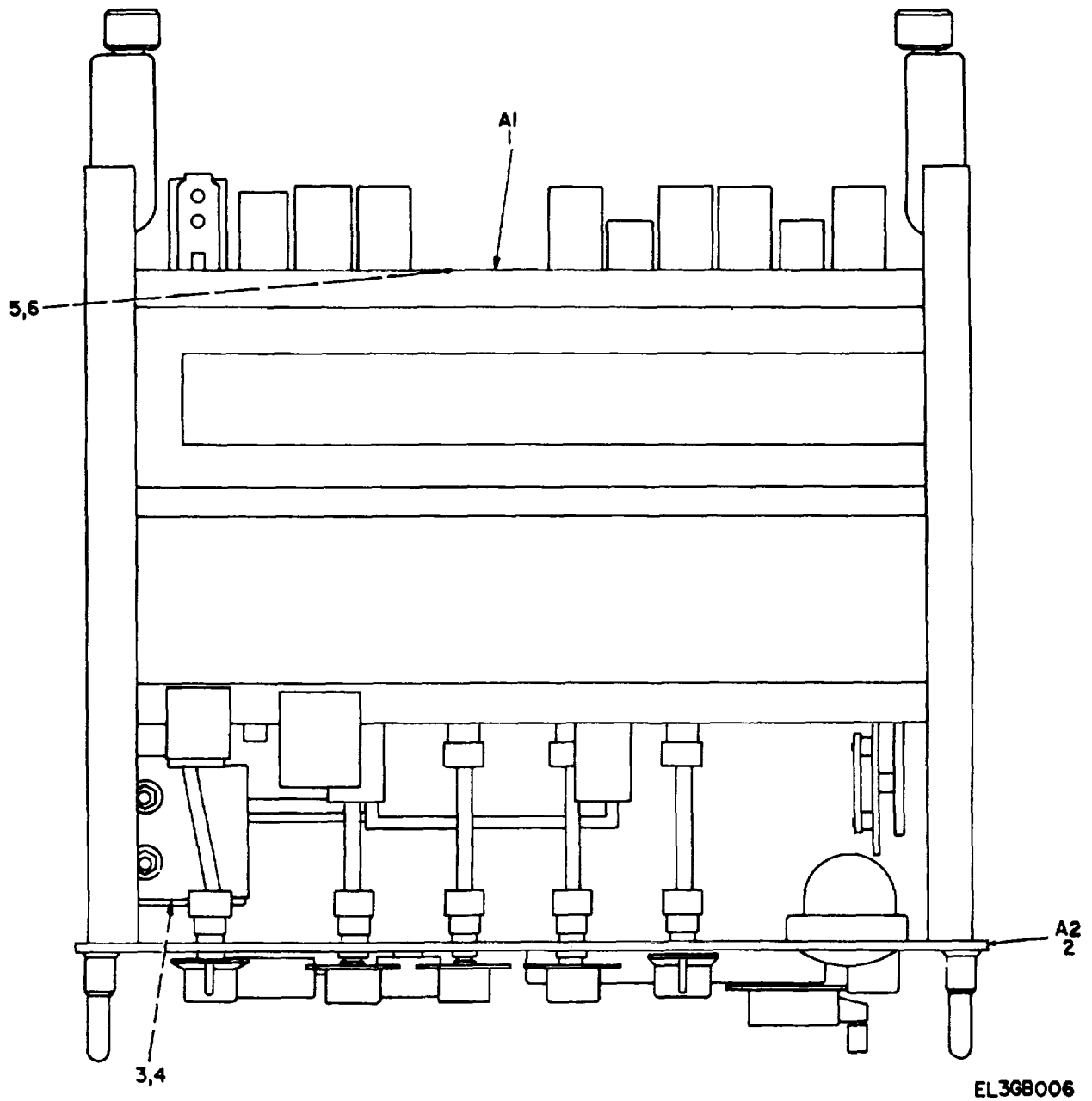

Figure 6. Signal Generator SG-756/URM, Top View, Cover Removed .



SECTION II

TM 11-6625-2520-24P

(1) ILLUSTRATION		(2)	(3)	(4)	(5)	(6)	(7)	(8)
(a) FIG NO.	(b) ITEM NO.	SMR CODE	NATIONAL STOCK NUMBER	PART NUMBER	FSCM	DESCRIPTION  USABLE ON CODE	U/M	QTY INC IN UNIT
6	1	PAHZZ	5930-00-219-5785	0618-624	28480	PULSER ASSEMBLY	EA	1
6	2	XDHHH		00618-620	28480	PANEL ASSY,FRONT	EA	1
6	3	XDHZZ		11608	73734	SCREW,MACHINE	EA	8
6	4	PAHZZ	5310-00-125-6170	MS215795-942	96906	WASHER,FLAT	EA	8
6	5	PAHZZ	5305-00-054-6668	MS51957-43	96906	SCREW,MACHINE	EA	4
6	6	PAHZZ	5310-00-905-5159	MS35335-87	96906	WASHER,LOCK	EA	4
					<b>15</b>			

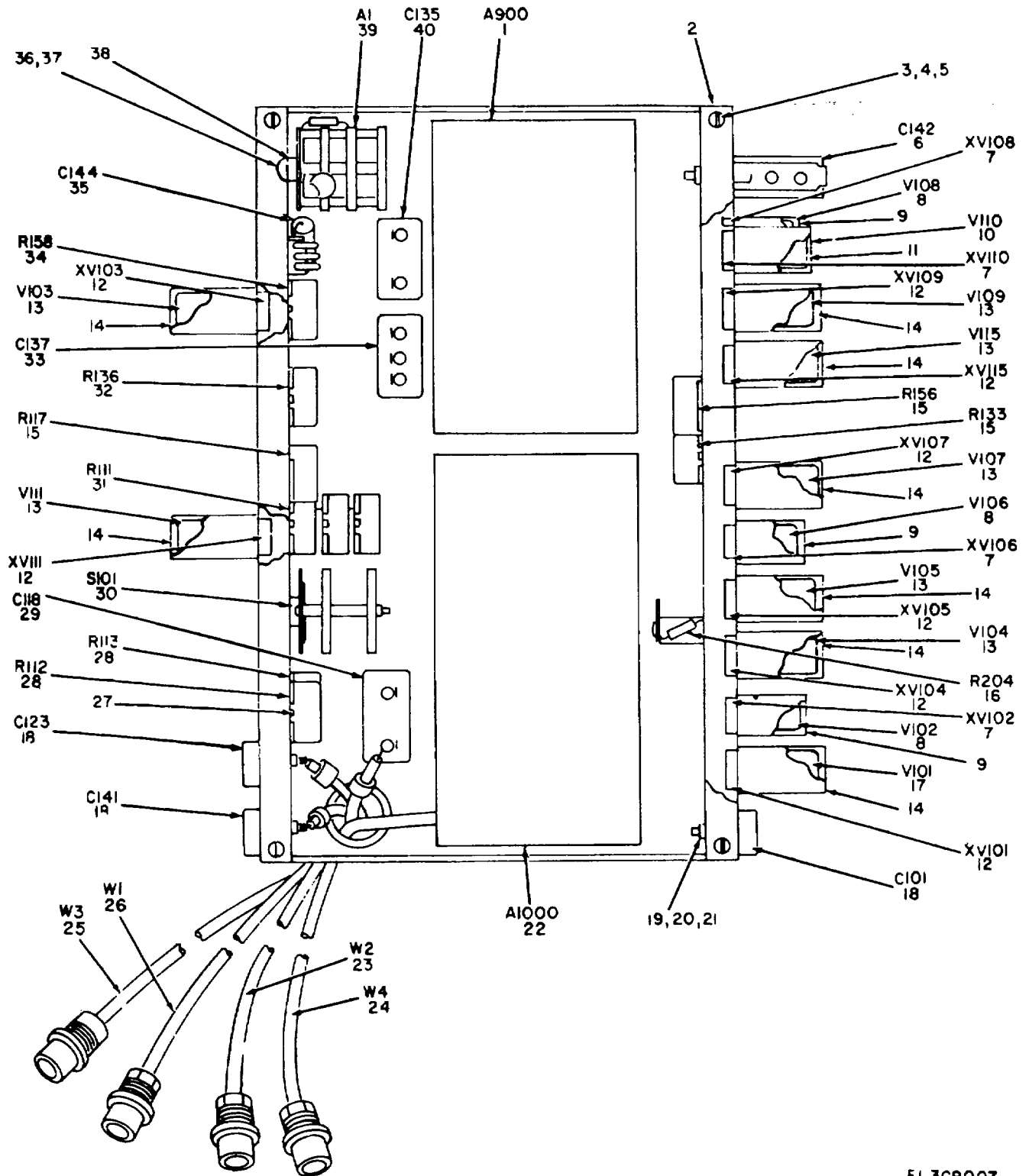

Figure 7. Pulsar Assembly A1 .

## SECTION II

TM 11-6625-2520-24P

(1) ILLUSTRATION		(2)	(3)	(4)	(5)	(6)	(7)	(8)
(a) FIG NO.	(b) ITEM NO.	SMR CODE	NATIONAL STOCK NUMBER	PART NUMBER	FSCM	DESCRIPTION  USABLE ON CODE	U/M	QTY INC IN UNIT
						GROUP 0101 PULSER ASSEMBLY A1		
7	1	PAHHH	6625-00-213-2633	00618-6077	28480	CRICUIT CARD,ASSY	EA	1
7	2	XDHZZ		00618-0052	28480	BRACKET,MOUNTING	EA	2
7	3	PAHZZ	5305-00-057-0523	MS51598-27	96906	SCREW,MACHINE	EA	8
7	4	PAHZZ	5310-00-939-0903	MS35335-86	96906	WASHER,LOCK	EA	4
7	5	PAHZZ	5310-00-934-9765	MS35650-304	96906	NUT,PLAIN,HEXAGON	EA	8
7	6	PAHZZ	5910-00-797-9731	0161-0088	28480	CAPACITOR,FXD,PAPER	EA	1
7	7	XDHZZ		111-39-11-018	71785	SOCKET,ELCTR N TUBE	EA	4
7	8	PAHZZ	5960-00-134-9919	6AL5	80131	ELECTRON TUBE	EA	3
7	9	XDHZZ		113-34-12-026	71785	SHIELD,ELCTR N TUBE	EA	3
7	10	PAHZZZ	5960-00-552-0082	1941-0005	28480	ELECTRON TUBE	EA	1
7	11	PAHZZ	5960-00-537-4737	150-11-23-012	71785	SHIELD,ELCTR N TUBE	EA	1
7	12	PAHZZ	5935-00-943-4072	121-31-12-104	71785	SOCKET,ELCTR N TUBE	EA	8
7	13	PAHZZ	5960-00-134-6012	6189W	81349	ELCETRON TUBE	EA	7
7	14	PAHZZ	5960-00-860-7710	95J241	71785	SHEILD,ELCTR N TUBE	EA	8
7	15	PAHZZ	5905-00-023-4837	2100-0025	28480	ERSISTOR,VARIABLE	EA	3
7	16	PAHZZ	5905-00-106-9344	RCR20G101JS	81349	RESISTOR,FXD,COMP	EA	1
7	17	PAHZZ	5960-00-615-5584	12AT7	80131	ELECTRON TUBE	EA	1
7	18	PAHZZ	5910-00-666-8475	CP55B1EG254K1	81349	CAPACITOR,FXD,PAPER	EA	3
7	19	PAHZZ	5310-00-934-9761	MS35649-264	96906	NUT,PLAIN,HEXAGON	EA	3
7	20	PAHZZ	5305-00-057-0524	MS51958-28	96906	SCREW,MACHINE	EA	14
7	21	PAHZZ	5310-00-939-0903	MS35335-86	96906	WASHER,LOCK	EA	14
7	22	PAHHH	6625-00-207-9969	00618-6078	28480	CIRCUIT CARD ASSY	EA	1
7	23	PAHHH	5995-00-139-5786	618816U	28480	CABLE ASSY,RF	EA	1
7	24	PAHHH	5995-00-139-5787	618861V	28480	CABLE ASSY,RF	EA	1
7	25	XDHZZ		618816S	28480	CABLE ASSY,RF	EA	1
7	26	PAHHH	5995-00-828-9167	618816T	28480	CABLE ASSY,RF	EA	1
7	27	XDHZZ		5020-0238	28480	COUPLING,SHAFT,RGD	EA	10
7	28	PAHZZ	5905-00-899-8779	2100-0029	28480	RESISTOR,VARIABLE	EA	2
7	29	PAHZZ	5910-00-112-6968	MILC25	81349	CAPACITOR,FXD,PAPER	EA	1
7	30	PAHZZ	5930-00-219-5785	00618-6079	28480	SWITCH,ROTARY	EA	1
7	31	PAHZZ	5905-00-919-8613	2100059	28480	RESISTOR,VARIABLE	EA	1
7	32	PAHZZ	5905-00-829-2827	2100-0047	28480	RESISTOR,VARIABLE	EA	1
7	33	PAHZZ	5910-00-666-5607	MILC25-4	81349	CAPACITOR,FXD,PAPER	EA	1
7	34	PAHZZ	5905-00-856-8688	2100-0051	28480	RESISTOR,VARIABLE	EA	1
7	35	XDHZZ		300202G050CC2	56289	CAPACITOR,FXD	EA	1
7	36	PAHZZ	5305-00-054-6668	MS51957-43	96906	SCREW,MACHINE	EA	13
7	37	PAHZZ	5305-00-054-6668	MS51957-43	96906	SCREW,MACHINE	EA	9
7	38	XDHZZ		00618-0049	28480	BRACKET,ANGLE	EA	2
7	39	XDHZZ		00618-6080	28480	SWITCH ASS,ROTARY	EA	1
					<b>17</b>			

SECTION II

TM 11-6625-2520-24P

(1) ILLUSTRATION		(2)	(3)	(4)	(5)	(6)	(7)	(8)
(a) FIG NO.	(b) ITEM NO.	SMR CODE	NATIONAL STOCK NUMBER	PART NUMBER	FSCM	DESCRIPTION  USABLE ON CODE	U/M	QTY INC IN UNIT
7	40	PAHZZ	5910-00-112-7117	CP54B1FF504K1	81349	CAPACITOR,FXD,PAPER	EA	1
<b>18/(19 blank)</b>								

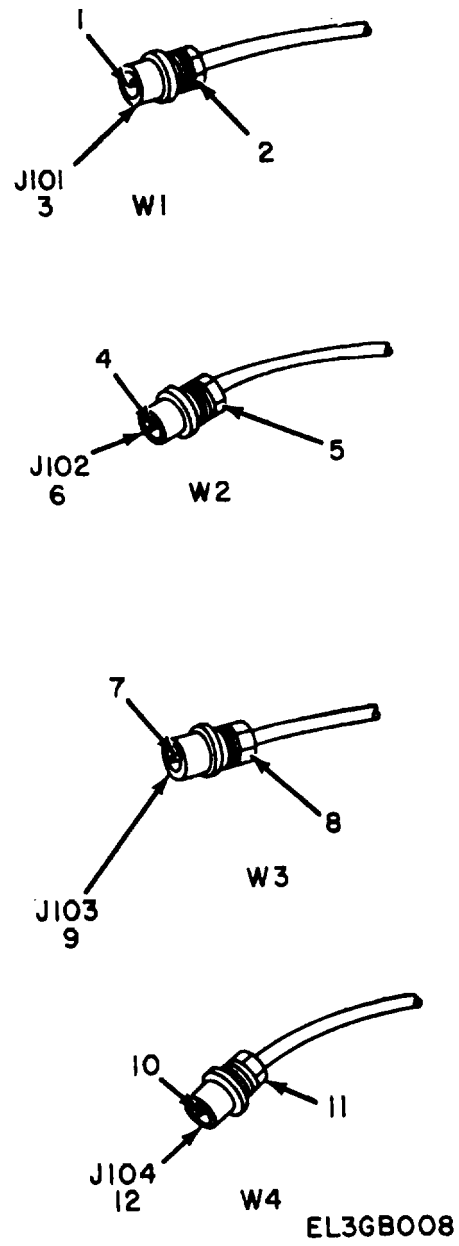

Figure 8. Cable Assemblies, Radio Frequency A1W1 Thru A1W4 .

SECTION II

TM 11-6625-2520-24P

(1) ILLUSTRATION		(2)	(3)	(4)	(5)	(6)	(7)	(8)
(a) FIG NO.	(b) ITEM NO.	SMR CODE	NATIONAL STOCK NUMBER	PART NUMBER	FSCM	DESCRIPTION  USABLE ON CODE	U/M	QTY INC IN UNIT
						GROUP 010101 CABLE ASSEMBLIES,RADIO FREQUENCY A1W1 THRU A1W4		
8	1	PAHZZ	5999-00-882-6993	1250-0051	28480	CONTACT,ELECTRIC	EA	1
8	2	PAHZZ	5365-00-453-6650	1250-0049	28480	NUT,CLAMP	EA	1
8	3	PAHZZ	5935-00-988-7758	1250-0102	28480	SHELL,ELEC CONN	EA	1
8	4	PAHZZ	599-00-882-6993	1250	28480	CONTACT,ELECTRIC	EA	1
8	5	PAHZZ	5365-00-453-6650	1250-0049	28480	NUT,CLAMP	EA	1
8	6	PAHZZ	5935-00-988-7758	1250-0102	28480	SHELL ELEC CONN	EA	1
8	7	PAHZZ	599-00-882-6993	1250-0051	28480	CONTACT,ELECTRIC	EA	1
8	8	PAHZZ	5365-00-453-6650	1250-0049	28480	NUT,CLAMP	EA	1
8	9	PAHZZ	5935-00-988-7758	1250-0102	28480	SHELL,ELEC CONN	EA	1
8	10	PAHZZ	599-00-882-6993	1250-0051	28480	CONTACT,ELECTRIC	EA	1
8	11	PAHZZ	5365-00-453-6650	1250-0049	28480	NUT,CLAMP	EA	1
8	12	PAHZZ	5935-00-988-7758	1250-0102	284480	SHELL,ELEC CONN	EA	1
					<b>21</b>			

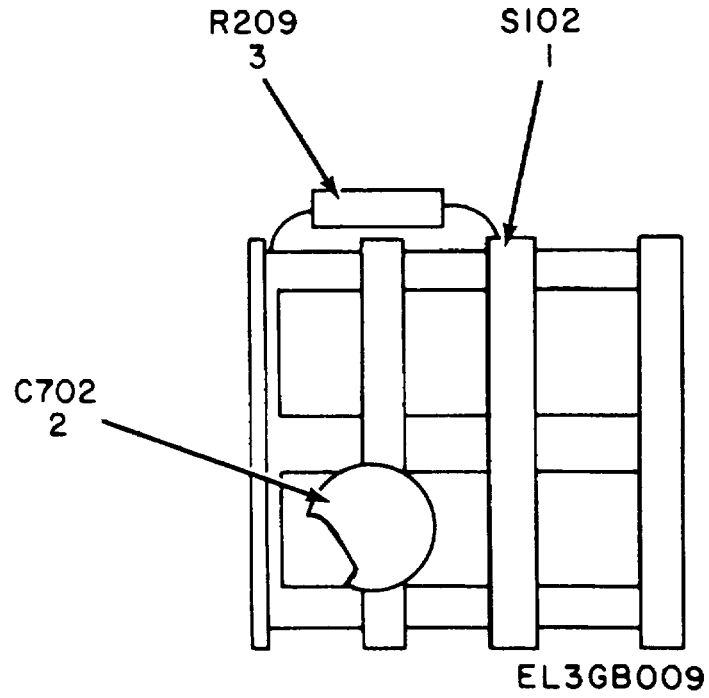

Figure 9. Switch Assembly, Rotary AA11 .

SECTION II

TM 11-6625-2520-24P

(1) ILLUSTRATION		(2)	(3)	(4)	(5)	(6) DESCRIPTION	(7)	(8)
(a) FIG NO.	(b) ITEM NO.	SMR CODE	NATIONAL STOCK NUMBER	PART NUMBER	FSCM	USABLE ON CODE	U/M	QTY INC IN UNIT
9	1	PAAHZZ	5930-00-205-98816	3100-2089	28480	GROUP 010102 SWITCH ASSEMBLY, ROTARY A1A1		
9	2	PAHZZ	5910-00-854-7130	30GA510	56289	SWITCH,ROTARY	EA	1
9	3	XDHZZ		MF7CD5620F	19701	CAPACITOR,FXD,CER RESISTOR,FXD,FILM	EA EA	1 1
23/(24 blank)								



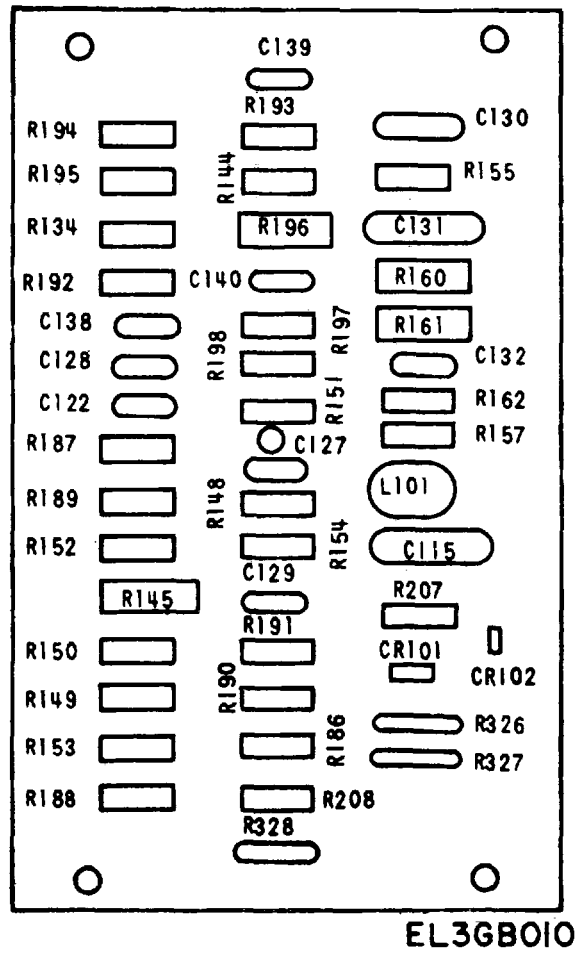

Figure 10. Circuit Card Assembly A1A900 (Sheet 1 of 2).

REF. DES.	ITEM NO.	REF. DES.	ITEM NO.	REF. DES.	ITEM NO.
CI15	1	RI45	11	RI89	16
CI12	2	RI48	12	RI90	12
CI27	3	RI49	13	RI91	21
CI28	2	RI50	14	RI92	17
CI29	3	RI51	15	RI93	22
CI30	4	RI52	15	RI94	17
CI31	1	RI53	16	RI95	23
CI32	3	RI54	16	RI96	18
CI38	5	RI55	17	RI97	24
CI39	3	RI57	15	RI98	25
CI40	5	RI60	18	R207	26
CR101	6	RI61	18	R208	27
CR102	7	RI62	19	R326	28
LI01	8	RI86	17	R327	29
RI34	9	RI87	17	R328	30
RI44	10	RI88	20		

EL3GB011

Figure 10. Circuit Card Assembly A1A900 (Sheet 2 of 2).

## SECTION II

TM 11-6625-2520-24P

(1) ILLUSTRATION		(2)	(3)	(4)	(5)	(6)	(7)	(8)
(a) FIG NO.	(b) ITEM NO.	SMR CODE	NATIONAL STOCK NUMBER	PART NUMBER	FSCM	DESCRIPTION  USABLE ON CODE	U/M	QTY INC IN UNIT
						GROUP 010103 CIRCUIT CARD ASSEMBLY A1A900		
10	1	PAHZZ	5910-00-976-3080	0160-2120	28480	CAPACITOR,FXD,MICA	EA	2
10	2	PAHZZ	5910-00-883-6281	28480	28480	CAPACITOR,FXD,MICA	EA	2
10	3	PAHZZ	5910-00-928-5344	0140-0206	28480	CAPACITOR,FXD,MICA	EA	4
10	4	PAHZZ	5910-00-919-0161	0140-0162	28480	CAPACITOR,FXD,MICA	EA	1
10	5	PAHZZ	5910-00-463-5949	0160-2204	28480	CAPACITOR,FXD,MICA	EA	2
10	6	PAHZZ	5961-00-950-0537	1901-0029	28480	SEMICONDUCTOR,DIODE	EA	1
10	7	PAHZZ	5961-00-904-0296	1901-0096	28480	SEMICONDUCTOR,DIODE	EA	1
10	8	PAHZZ	5915-00-816-7231	618860A	28480	COIL,RF	EA	1
10	9	PAHZZ	5905-00-252-1050	RCR32G393JS	81349	RESISTOR,FXD,COMP	EA	1
10	10	PAHZZ	5905-00-369-6916	RCR32G122JS	81349	RESISTOR,FXD,COMP	EA	1
10	11	PAHZZ	5905-00-184-7703	RCR42G103JS	81349	RESISTOR,FXD,COMP	EA	1
10	12	PAHZZ	5905-00-104-8351	RCR32G154JS	81349	RESISTOR,FXD,COMP	EA	2
10	13	PAHZZ	5905-00-252-1047	RCR32G274JS	81349	RESISTOR,FXD,COMP	EA	1
10	14	PAHZZ	5905-00-400-4510	RCR32G564JS	81349	RESISTOR,FXD,COMP	EA	3
10	15	PAHZZ	5905-00-111-8372	RCR32G222JS	81349	RESISTOR,FXD,COMP	EA	3
10	16	PAHZZ	5905-00-106-9353	RC 32G474JS	81349	RESISTOR,FXD,COMP	EA	3
10	17	PAHZZ	5905-00-369-6929	RCR32G473JS	81349	RESISTOR,FXD,COMP	EA	5
10	18	PAHZZ	5905-00-222-2144	RCR42G333JS	81349	RESISTOR,FXD,COMP	EA	3
10	19	PAHZZ	5905-00-247-8684	RCR32G105JS	81349	RESISTOR,FXD,COMP	EA	1
10	20	PAHZZ	5905-00-106-1276	RCR32G104JS	81349	RESISTOR,FXD,COMP	EA	1
10	21	PAHZZ	5905-00-133-0379	RCR32G184JS	81349	RESISTOR,FXD,COMP	EA	1
10	22	PAHZZ	5905-00-104-8353	RCR32G472S	81349	RESISTOR,FXD,COMP	EA	1
10	23	PAHZZ	5905-00-106-9346	RCR32G103JS	81349	RESISTOR,FXD,COMP	EA	1
10	24	PAHZZ	5905-00-113-4850	RCR32G125JS	81349	RESISTOR,FXD,COMP	EA	1
10	25	PAHZZ	5905-00-106-9346	RCR32G103JS	81349	RESISTOR,FXD,COMP	EA	1
10	26	PAHZZ	5905-00-247-8733	RCR32G526JS	81349	RESISTOR,FXD,COMP	EA	1
10	27	PAHZZ	5905-00-247-8749	RCR32G823JS	81349	RESISTOR,FXD,COMP	EA	1
10	28	XDHZZ		MF7CD6192F	19701	RESISTOR,FXD,COMP	EA	1
10	29	PAHZZ	5905-00-930-7959	MF7CD6192F	19701	RESISTOR,FXD,COMP	EA	1
10	30	PAHZZ	5905-00-927-2876	MF7CD3923F	19701	RESISTOR,FXD,COMP	EA	1
<b>27/(28 blank)</b>								

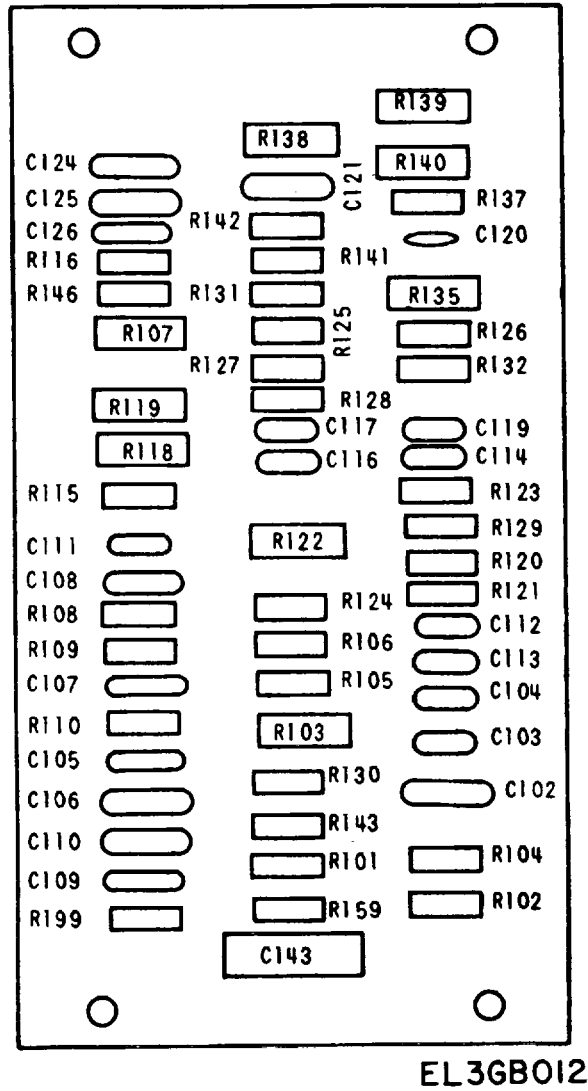

Figure 11. Circuit Card Assembly A1A1000 (Sheet 1 of 2).

REF. DES.	ITEM NO.	REF. DES.	ITEM NO.	REF. DES.	ITEM NO.
CI02	1	CI26	13	RI24	27
CI03	2	CI43	14	RI25	20
CI04	3	RI01	15	RI26	28
CI05	4	RI02	15	RI27	28
CI06	1	RI03	16	RI28	15
CI07	4	RI04	15	RI29	28
CI08	5	RI05	17	RI30	27
CI09	4	RI06	18	RI31	29
CI10	1	RI07	19	RI32	15
CI11	6	RI08	20	RI35	30
CI12	7	RI09	18	RI37	31
CI13	8	RI10	17	RI38	24
CI14	9	RI15	21	RI39	24
CI16	10	RI16	22	RI40	24
CI17	6	RI18	23	RI41	18
CI19	11	RI19	24	RI42	32
CI20	12	RI20	25	RI43	15
CI21	1	RI21	26	RI46	33
CI24	1	RI22	19	RI59	34
CI25	1	RI23	17	RI99	27

EL3GB013

Figure 11. Circuit Card Assembly A1A1000 (Sheet 2 of 2).

## SECTION II

TM 11-6625-2520-24P

(1) ILLUSTRATION		(2)	(3)	(4)	(5)	(6) DESCRIPTION	(7)	(8)
(a) FIG NO.	(b) ITEM NO.	SMR CODE	NATIONAL STOCK NUMBER	PART NUMBER	FSCM	USABLE ON CODE	U/M	QTY INC IN UNIT
						GROUP 010104 CIRCUIT CARD ASSEMBLY A1A1000		
11	1	PAHZZ	5910-00-976-3080	0160-2120	28480	CAPACITOR,FXD,MICA	EA	6
11	2	PAHZZ	5910-00-686-7110	0140-0149	28480	CAPACITOR,FXD,MICA	EA	1
11	3	PAHZZ	5910-00-544-6742	1040-0197	28480	CAPACITOR,FXD,MICA	EA	1
11	4	PAHZZ	5910-00-920-3776	0140-0209	28480	CAPACITOR,FXD,MICA	EA	3
11	5	PAHZZ	5910-00-329-4801	0160-3493	28480	CAPACITOR,FXD,MICA	EA	1
11	6	PAHZZ	5910-00-463-5949	0160-2204	28480	CAPACITOR,FXD,MICA	EA	2
11	7	PAHZZ	5910-00-075-9238	MILC5-18	81439	CAPACITOR,FXD,MICA	EA	1
11	8	PAHZZ	5910-00-920-3776	0140-0209	28480	CAPACITOR,FXD,MICA	EA	1
11	9	PAHZZ	5910-00-085-0438	0140-0191	28480	CAPACITOR,FXD,MICA	EA	1
11	10	PAHZZ	5910-00-883-6281	0160-2306	28480	CAPACITOR,FXD,MICA	EA	1
11	11	PAHZZ	5910-00-928-5344	140-0206	28480	CAPACITOR,FXD,MICA	EA	1
11	12	PAHZZ	5910-00-959-5209	C016B102E401J	56289	CAPACITOR,FXD,CER	EA	1
11	13	PAHZZ	5910-00-891-4245	0140-0157	58480	CAPACITOR,FXD,MICA	EA	1
11	14	PAHZZ	5910-00-817-7275	148P22492	56289	CAPACITOR,FXD,PLSTC	EA	1
11	15	PAHZZ	5905-00-113-4850	RCR32G125JS	81349	RESISTOR,FXD,COMP	EA	6
11	16	PAHZZ	5905-00-874-0147	RCR42G473JS	81349	RESISTOR,FXD,COMP	EA	1
11	17	PAHZZ	5905-00-369-6929	RCR32G473JS	81349	RESISTOR,FXD,COMP	EA	3
11	18	PAHZZ	5905-00-106-1276	RCR32G104JS	81349	RESISTOR,FXD,COMP	EA	3
11	19	PAHZZ	5905-00-152-8376	RCR42G273JS	81349	RESISTOR,FXD,COMP	EA	2
11	20	PAHZZ	5905-00-106-9353	RCR32G474JS	81349	RESISTOR,FXD,COMP	EA	2
11	21	PAHZZ	5905-00-247-8684	RCR32G105JS	81349	RESISTOR,FXD,COMP	EA	1
11	22	PAHZZ	5905-00-235-3534	RCR32G681JS	81349	RESISTOR,FXD,COMP	EA	1
11	23	PAHZZ	5905-00-001-3031	RCR42G183JS	81349	RESISTOR,FXD,COMP	EA	1
11	24	PAHZZ	5905-00-184-7703	RCR42G103JS	81349	RESISTOR,FXD,COMP	EA	4
11	25	PAHZZ	5905-00-104-8353	RCR32GJ72JS	81349	RESISTOR,FXD,COMP	EA	1
11	26	PAHZZ	5905-00-106-1245	RCR32G272JS	81349	RESISTOR,FXD,COMP	EA	1
11	27	PAHZZ	5905-00-369-6916	RCR32G122JS	81349	RESISTOR,FXD,COMP	EA	3
11	28	PAHZZ	5905-00-016-9346	RCR32G103JS	81349	RESISTOR,FXD,COMP	EA	3
11	29	PAHZZ	5905-00-252-1047	RCR32G274JS	81349	RESISTOR,FXD,COMP	EA	1
11	30	PAHZZ	5905-00-222-2144	RCR42G333JS	81349	RESISTOR,FXD,COMP	EA	1
11	31	PAHZZ	5905-00-247-8722	RCR32G271JS	81349	RESISTOR,FXD,COMP	EA	1
11	32	PAHZZ	5905-00-104-8351	RCR32G154JS	81349	RESISTOR,FXD,COMP	EA	1
11	33	PAHZZ	5905-0-247-8700	RCR32G124JS	81349	RESISTOR,FXD,COMP	EA	1
11	34	PAHZZ	5905-00-104-8347	RCR32G101JS	81349	RESISTOR,FXD,COMP	EA	1
					<b>31</b>			

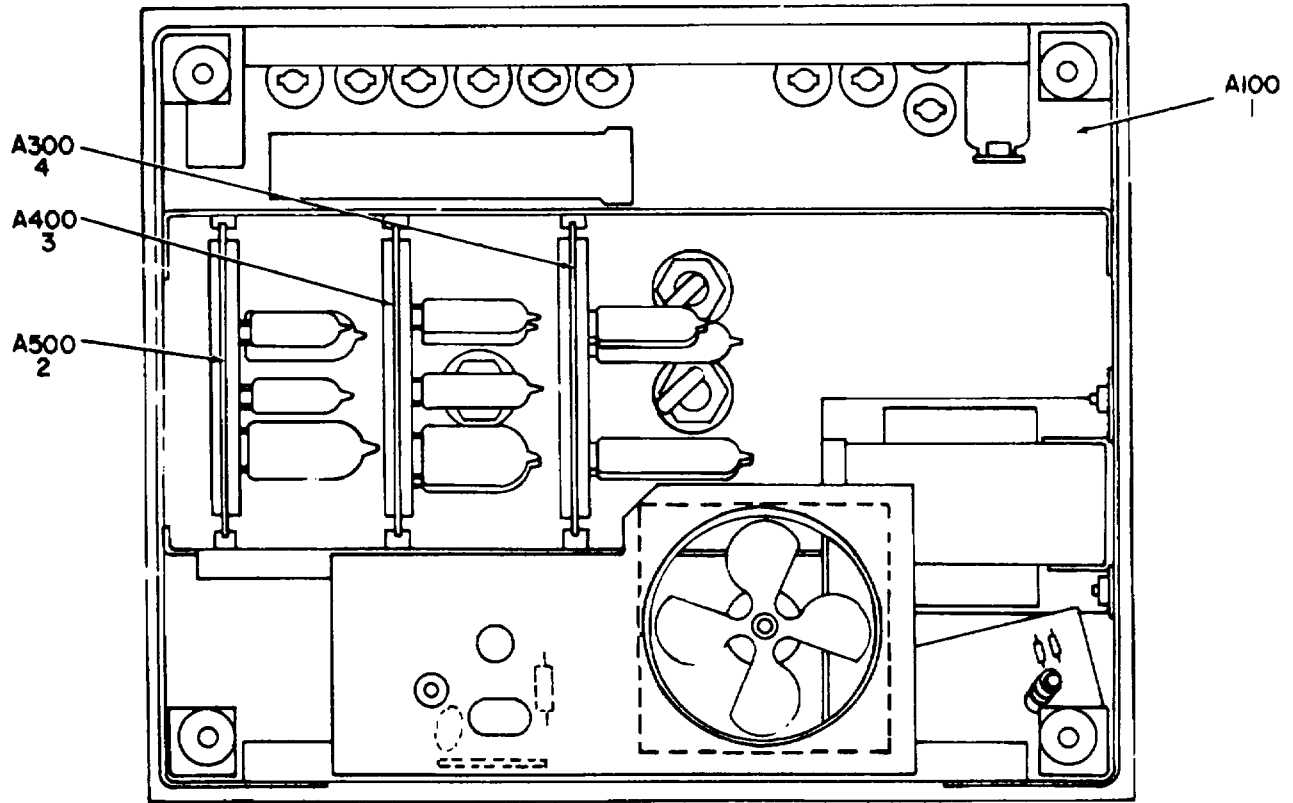

EL3GB014

Figure 12. Front Panel Assembly, Rear Interior View .

SECTION II

TM 11-6625-2520-24P

(1) ILLUSTRATION		(2)	(3)	(4)	(5)	(6)	(7)	(8)
(a) FIG NO.	(b) ITEM NO.	SMR CODE	NATIONAL STOCK NUMBER	PART NUMBER	FSCM	DESCRIPTION  USABLE ON CODE	U/M	QTY INC IN UNIT
						GROUP 0102 FRONT PANEL ASSEMBLY		
12	1	PAHHH	6625-00-207-9967	00618-6076	28480	CIRCUIT CARD ASSEMBLY	EA	1
12	2	XDHHH		00618-6062	28480	CIRCUIT CARD ASSEMBLY	EA	1
12	3	XDHHH		00618-6061	28480	CIRCUIT CARD ASSEMBLY	EA	1
12	4	XDHHH		00618-6060	28480	CIRCUIT CARD ASSEMBLY	EA	1
					<b>33</b>			



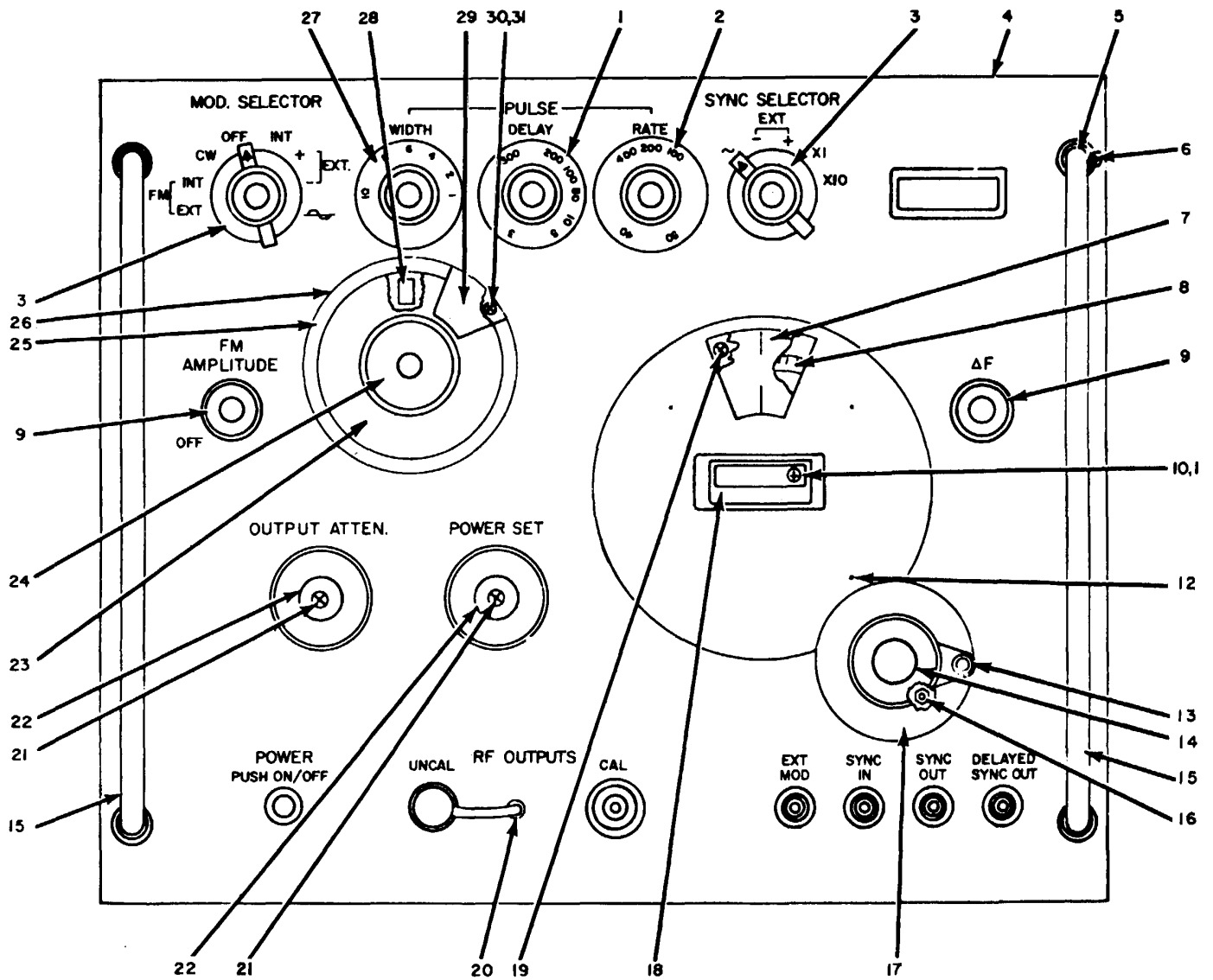

EL 3GB015

Figure 13. Front Panel Assembly, Front View .

## SECTION II

TM 11-6625-2520-24P

(1) ILLUSTRATION		(2)	(3)	(4)	(5)	(6)	(7)	(8)
(a) FIG NO.	(b) ITEM NO.	SMR CODE	NATIONAL STOCK NUMBER	PART NUMBER	FSCM	DESCRIPTION  USABLE ON CODE	U/M	QTY INC IN UNIT
13	1	PAHZZ	5355-00-816-8372	618840F	28480	DAIL,CONTROL	EA	1
13	2	PAHZZ	5355-00-816-8373	618840G	28480	DIAL,CONTROL	EA	1
13	3	PAOZZ	5355-00-547-7996	0370-0035	28480	KNOB	EA	2
13	4	XDHZZ		00618-020	28480	PANEL,BLANK	EA	1
13	5	XDHH		61B3AT	28480	FERRULE,HANDLE	EA	4
13	6	XDHH		4233	73734	SCREW,MACHINE	EA	4
13	7	PAHZZ	535-00-667-7900	61B40D1	28480	WINDOW,DIAL	EA	1
13	8	PAHZZ	6625-00-772-6119	61B40D4	28480	PLATE,MOUNTING,DIAL	EA	1
13	9	PADZZ	535-00-646-4704	0370-0029	28480	KNOB	EA	2
13	10	PAHZZ	5305-00-958-5473	MS35190-251	96906	SCREW,MACHINE	EA	4
13	11	PAHZZ	5310-00-905-5159	MS35335-87	96906	WASHER,LOCK	EA	4
13	12	PAHZZ	5305-00-957-6645	MS35190-233	96906	SCREW,MACHINE	EA	4
13	13	PAHZZ	6625-00-818-5973	1410-0033	28480	POST,ELCTRNMECH	EA	1
13	14	PAOZZ	5355-00-579-2318	0370-0050	28480	KNOB	EA	1
13	15	XDHZZ		61883E	28480	HANDLE,BOW	EA	2
13	16	XDHZZ		61883C	28480	NUT,SELF-LOCKING,HEX	EA	1
13	17	XDHZZ		618840P	28480	DIAL,CONTROL	EA	1
13	18	XDHZZ		7120-1269	28480	PLATE,IDENT	EA	1
13	19	PAHZZ	6625-00-445-6775	5020-0234	28480	HUB	EA	1
13	20	PAHZZ	5365-00-937-0638	1250-0016	28480	RING,RETAINING	EA	1
13	21	XDHZZ		18000	73734	SCREW,MACHINE	EA	3
13	22	PAOZZ	5355-00-543-0066	0370-0038	28480	KNOB	EA	2
13	23	XDHZZ		618840C	28480	DIAL,SCALE	EA	1
13	24	PAHZZ	5355-00-788-6925	61B40B1	28480	COVER,HUB	EA	1
13	25	PAHZZ	5355-00-401-3244	618B40E	28480	DIAL,CONTROL	EA	1
13	26	PAHZZ	5355-00-401-3243	618840B	28480	COVER,DIAL	EA	1
13	27	PAHZZ	5355-00-816-8374	618840H	28480	DIAL,CONTROL	EA	1
13	28	XDHZZ		618847C	28480	SPACER,SLEVE	EA	2
13	29	PAHZZ	5355-00-930-2692	5040-0216	28480	WINDOW,DIAL	EA	1
13	30	PAHZZ	5305-00-054-5636	MS51957-2	96906	SCREW,MACHINE	EA	2
13	31	XDHZZ		MS35333-120	96906	WASHER,LOCK	EA	2
					<b>35</b>			

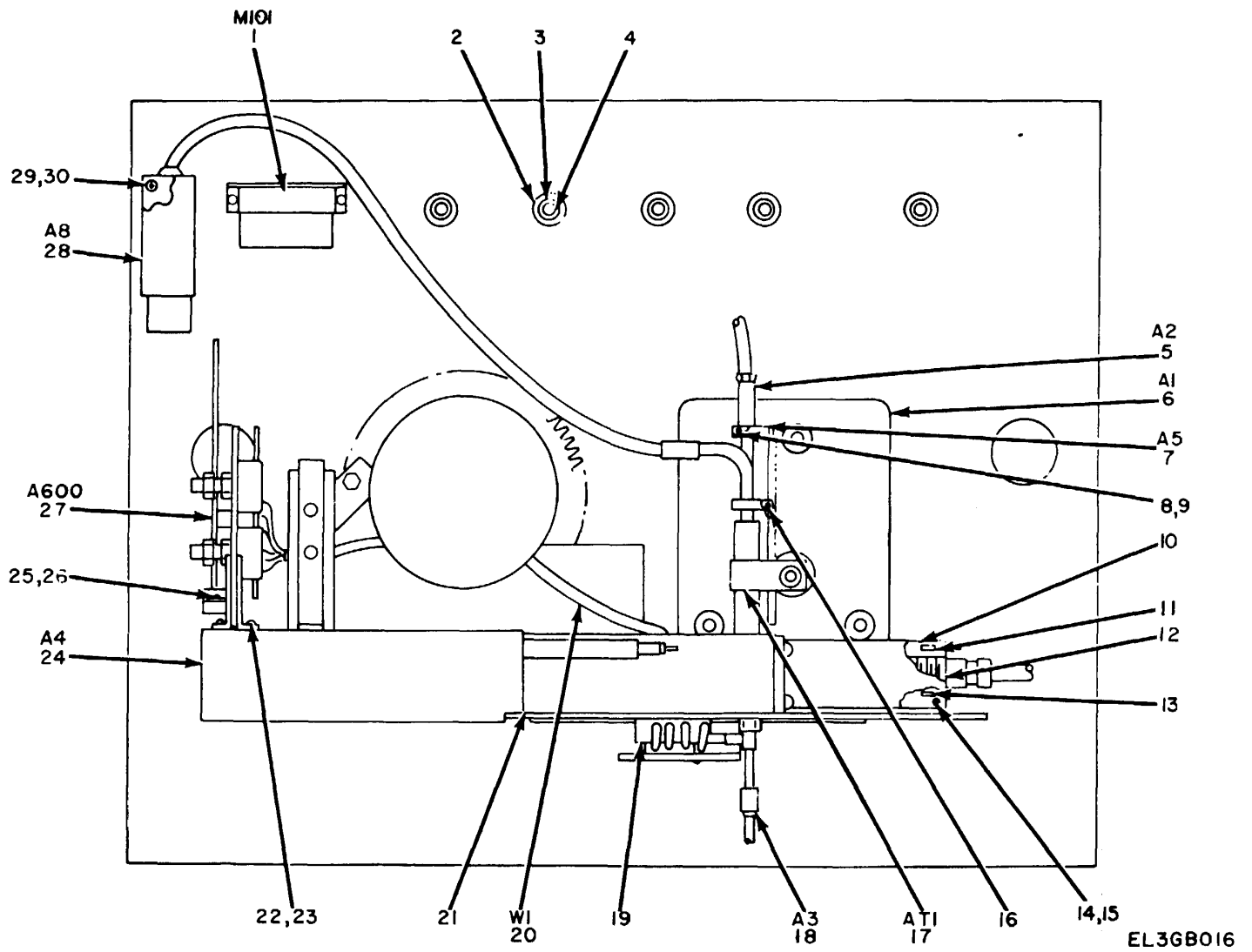
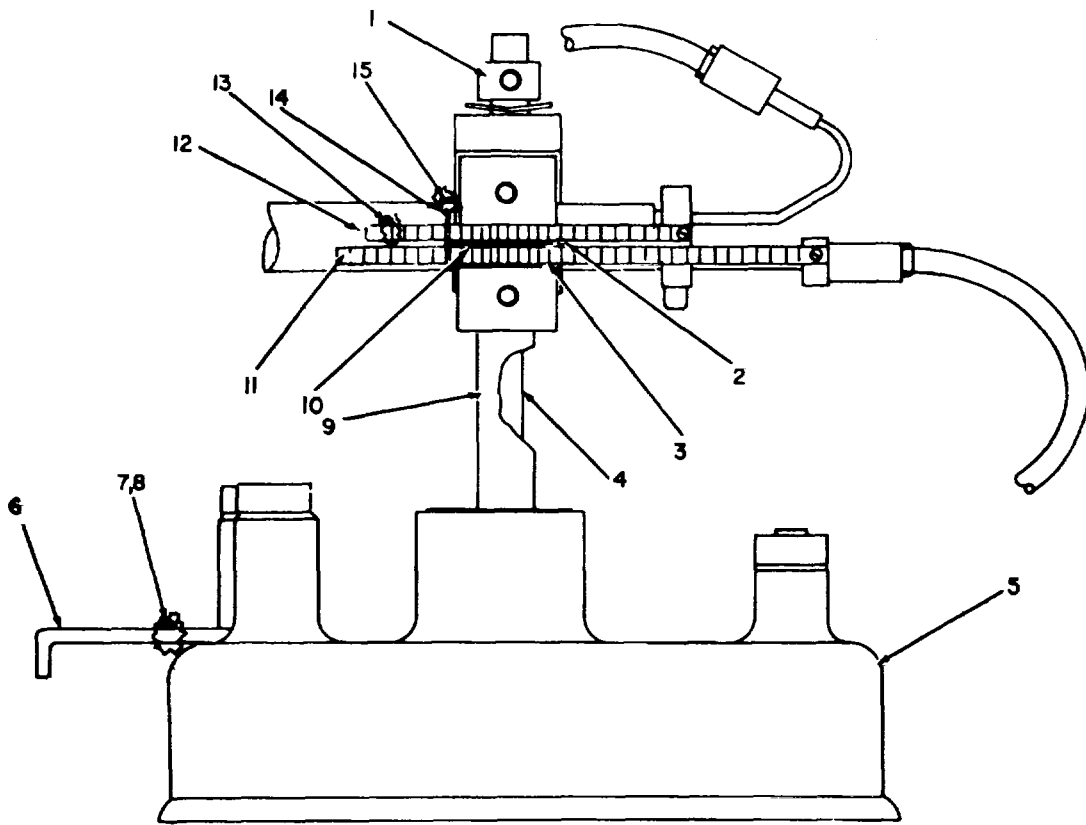

Figure 14. Front Panel Assembly, Rear View .

## SECTION II

TM 11-6625-2520-24P

(1) ILLUSTRATION		(2)	(3)	(4)	(5)	(6)	(7)	(8)
(a) FIG NO.	(b) ITEM NO.	SMR CODE	NATIONAL STOCK NUMBER	PART NUMBER	FSCM	DESCRIPTION  USABLE ON CODE	U/M	QTY INC IN UNIT
14	1	PAHZZ	6625-00-998-6521	1120-1277	28480	AMMETER	EA	1
14	2	PAHZZ	3040-00-898-1548	5020-0319	28480	SHAFT	EA	5
14	3	PAHZZ	5365-00-203-0375	1410-0003	28480	BUSHING,SLEVE	EA	5
14	4	XDHZZ		5020-0318	28480	SHAFT,COUPLING	EA	5
14	5	XDHHH		00618-646	28480	PROBE ASSEMBLY	EA	1
14	6	XDHHH		618835	28480	DRIVE ASSY,ALTNTR	EA	1
14	7	XDHHH		00618-6071	28480	DIVIDER ASSEMBLY	EA	1
14	8	PAHZZ	5305-00-057-0524	MS51958-28	96906	SCREW,MACHINE	EA	1
14	9	PAHZZ	5310-00-939-0903	MS35335-86	96906	WASHER,LOCK	EA	1
14	10	PAHZZ	5960-00-387-6261	61883D	28480	SHIELD,ELCTR N TUBE	EA	1
14	11	XDHZZ		61883G	28480	CONTACT,ELECTRIC	EA	2
14	12	PAHZZ	5360-00-624-8953	61883F	28480	SPRING,HLCL EXT	EA	1
14	13	XDHZZ		00618-2046	28480	STRIP,INSULATOR	EA	1
14	14	PAHZZ	5310-00-930-2722	50000206	28480	WASHER,LOCK	EA	1
14	15	XDHZZ		2190-0496	28480	WASHER,NONMETALLIC	EA	1
14	16	PAHZZ	5305-00-057-0526	MS51958-30	96906	SCREW,MACHINE	EA	1
14	17	PAHZZ	5985-00-833-2427	618834AA	28480	ATTENUATOR ASSY FXD	EA	1
14	18	PAHHH	6625-00-998-6522	00618-640	28480	PROBE ASSEMBLY	EA	1
14	19	PAHZZ	5365-00-150-4945	0380-0081	28480	SPACER,SLEEVE	EA	2
14	20	XDHHH		00618-6072	28480	WIRING HARN,BR	EA	1
14	21	PAHZZ	5365-00-808-7384	61888A	28480	RING,SEATING	EA	1
14	22	PAHZZ	5305-00-054-5646	MS51957-12	96906	SCREW,MACHINE	EA	2
14	23	PAHZZ	5310-00-939-1063	MS35335-85	96906	WASHER,LOCK	EA	2
14	24	XDHHH		00618-622	28480	CONTROL ASSY,FREQ	EA	1
14	25	PAHZZ	5305-00-054-5651	MS51957-17	96906	SCREW,MACHINE	EA	3
14	26	PAHZZ	5310-00-543-2410	MS35338-40	96906	WASHER,LOCK	EA	1
14	27	PAHHH	5935-00-931-0420	00618-632	28480	CIRCUIT CARD ASSY	EA	1
14	28	PAHZZ	6625-00-406-4318	00618-628	28480	DETECTOR ASSY	EA	1
14	29	PAHZZ	5305-00-958-5473	MS35190-251	96906	SCREW,MACHINE	EA	3
14	30	PAHZZ	5310-00-905-5159	MS35333-87	96906	WASHER,LOCK	EA	3
					<b>37</b>			



SIDE VIEW

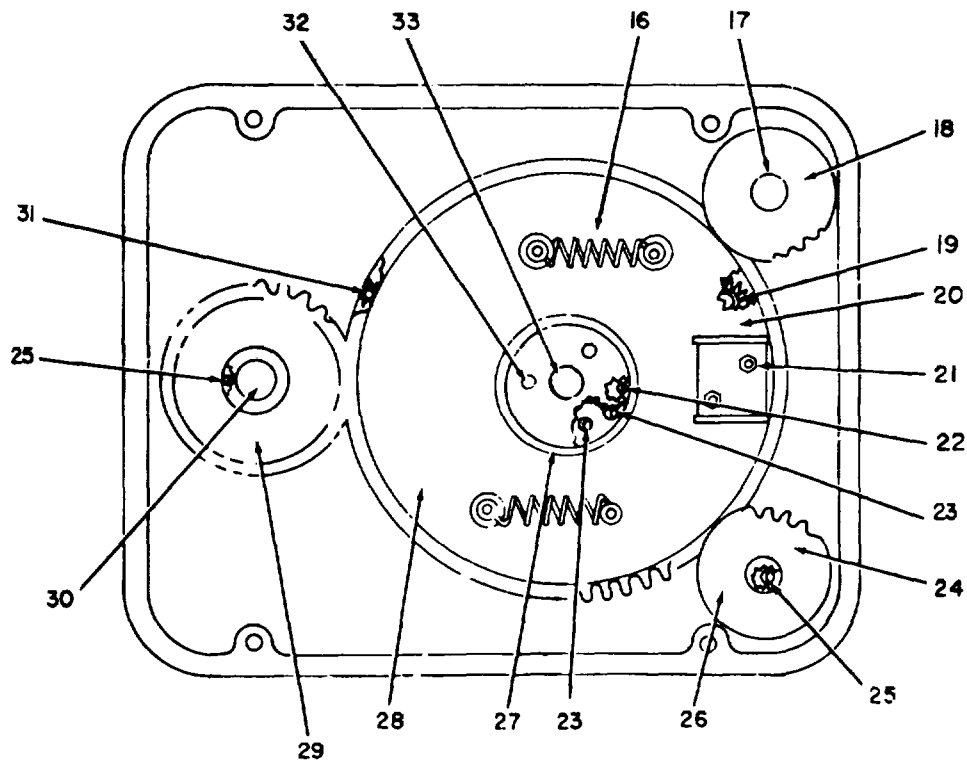

BOTTOM VIEW

EL3GB017

Figure 15. Drive Assembly A2A1 .

## SECTION II

TM 11-6625-2520-24P

(1) ILLUSTRATION		(2)	(3)	(4)	(5)	(6)	(7)	(8)
(a) FIG NO.	(b) ITEM NO.	SMR CODE	NATIONAL STOCK NUMBER	PART NUMBER	FSCM	DESCRIPTION  USABLE ON CODE	U/M	QTY INC IN UNIT
						GROUP 010201 DRIVE ASSEMBLY A2A1		
15	1	PAHZZ	3004-00-127-2837	5020-0233	28480	COLLAR,SHAFT	EA	4
15	2	PAHZZ	3020-00-593-5141	618835T	28480	GEAR,SPUR	EA	1
15	3	PAHZZ	3020-00-831-5994	618835R	28480	GEAR,SPUR	EA	1
15	4	XDHZZ		6188351	28480	SHAFT,SHOULDERED	EA	1
15	5	XDHZZ		618835A	28480	HOUSING,MECH DRIVE	EA	1
15	6	XDHZZ		618847A	28480	BRACKET,ANGLE	EA	1
15	7	XDHZZ		22044	73734	SCREW,MACHINE	EA	2
15	8	PAHZZ	5310-00-939-0903	MS35335-86	96906	WASHER,LOCK	EA	2
15	9	PAHZZ	6625-00-594-0458	618835E	28480	DRIVERSHAFT,HUB	EA	1
15	10	XDHZZ	3120-00-097-5004	624B59C5	28480	BUSHING,SLEEVE	EA	1
15	11	PAHZZ	3020-00-031-1018	618835PL	28480	GEAR RACK	EA	1
15	12	PAHZZ	3020-00-031-1019	618835PS	28480	GEAR RACK	EA	1
15	13	PAHZZ	5305-00-860-1749	MS35199-10	96906	SCREW,MACHINE	EA	2
15	14	PAHZZ	6625-00-034-6690	620A91A	28480	SPRING,RACK LOAD	EA	1
15	15	PAHZZ	5310-00-930-2722	5000-0206	28480	WASHER,LOCK	EA	8
15	16	XDHZZ		1460-0048	28480	SPRING,HLCL EXT	EA	4
15	17	XDHZZ		5020-0256	28480	SHAFT,STRAIGHT	EA	2
15	18	PAHZZ	3020-00-594-0552	618835Q	28480	GEAR,SPUR	EA	1
15	19	PAHZZ	3020-00-600-0794	618835L	28480	GEAR,SPUR	EA	1
15	20	PAHZZ	3020-00-600-7080	618835N	28480	GEAR,SPUR	EA	1
15	21	XDHZZ		618835H	28480	BRACKET,MTG,GEAR	EA	1
15	22	PAHZZ	3110-00-044-4155	S1KDD7FS58115	86174	BEARING,BALL,ANLR	EA	1
15	23	PAHZZ	3110-00-068-0067	S3KDDFS58115	86174	BEARING,BALL,ANLR	EA	2
15	24	PAHZZ	3020-00-589-9680	618835V	28480	GEAR,SPUR	EA	1
15	25	XDHZZ		33K5FS5115	86174	BEARING,BALL,ANLR	EA	2
15	26	XDHZZ		618835U	28480	GEAR,SPUR	EA	1
15	27	XDHZZ		618835D	28480	SPACER,SLEEVE	EA	1
15	28	XDHZZ		618835M	28480	GEAR,SPUR	EA	1
15	29	PAHZZ	3020-00-594-0555	618835S	28480	GEAR,SPUR	EA	1
15	30	XDHZZ		618835J	28480	SHAFT,STRAIGHT	EA	1
15	31	PAHZZ	3020-00-600-7084	618835K	28480	GEAR,SPUR	EA	1
15	32	PAHZZ	5305-00-957-6640	MS35190-259	96906	SCREW,MACHINE	EA	3
15	33	PAHZZ	4290-00-382-9486	618835G	28480	HUB,GEAR	EA	1
					<b>39</b>			

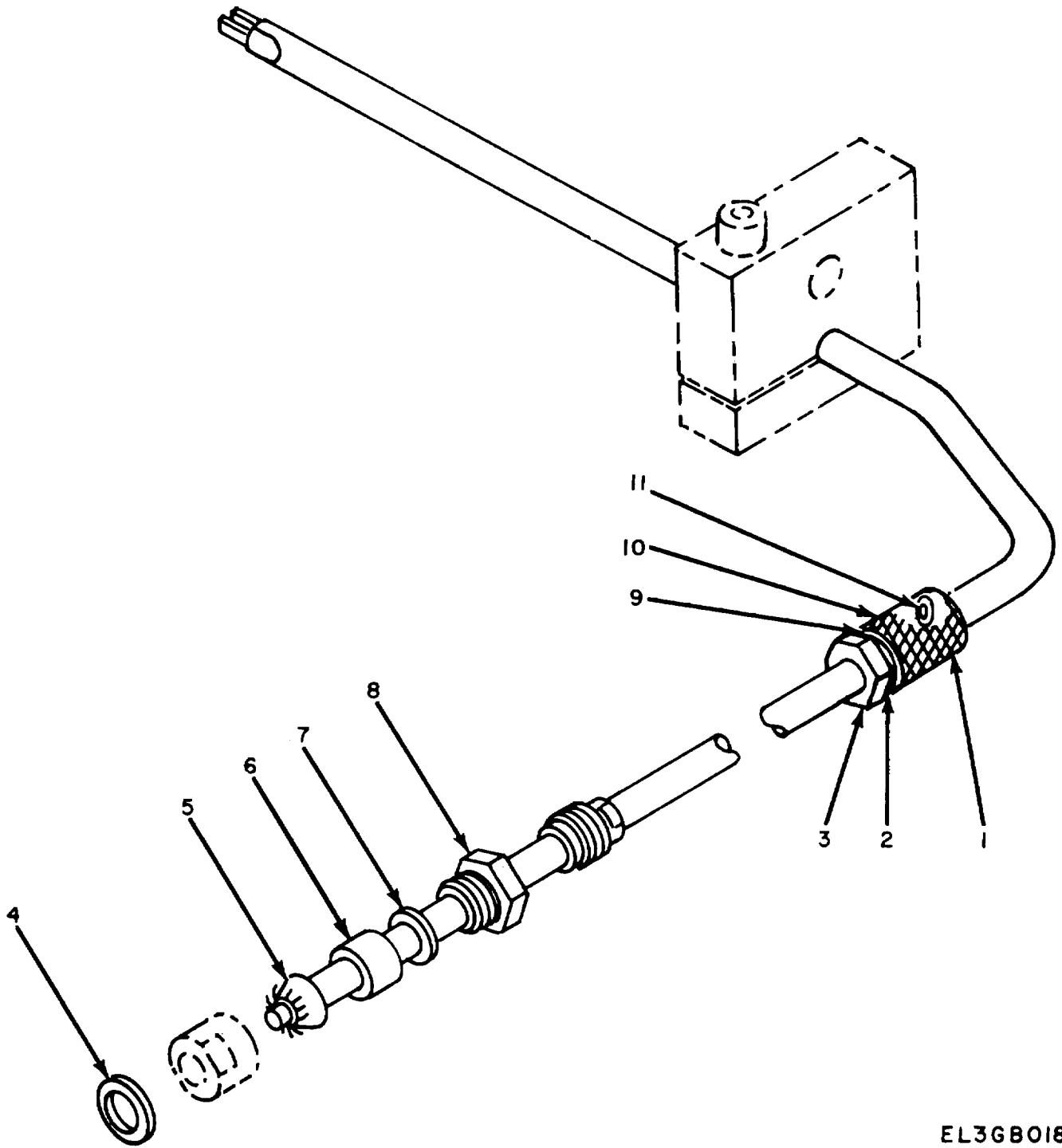

EL3GB018

Figure 16. Probe Assembly A2A2 .

SECTION II

TM 11-6625-2520-24P

(1) ILLUSTRATION		(2)	(3)	(4)	(5)	(6) DESCRIPTION	(7)	(8)
(a) FIG NO.	(b) ITEM NO.	SMR CODE	NATIONAL STOCK NUMBER	PART NUMBER	FSCM	USABLE ON CODE	U/M	QTY INC IN UNIT
						GROUP 010202 PROBE ASSEMBLY A2A2		
16	1	XDHZZ		1250-0141	28480	BODY,CONNECTOR	EA	1
16	2	XDHZZ		1250-0006	28480	WASHER,FLAT	EA	1
16	3	XDHZZ		1250-0147	28480	NUT,RETAINING	EA	1
16	4	PAHZZ	5970-00-933-4602	1250-0148	28480	INSULATOR,WASHER	EA	1
16	5	PAHZZ	5935-00-937-4421	1250-0143	28480	WASHER,CLAMP	EA	1
16	6	PAHZZ	5330-00-973-8288	1250-0145	28480	GASKET	EA	1
16	7	PAHZZ	5310-00-937-0650	1250-0146	28480	WASHER,FLAT	EA	1
16	8	PAHZZ	5975-00-931-4820	1250-0142	28480	BUSHING,MACH THREAD	EA	1
16	9	PAHZZ	5365-00-882-0401	88-28	91737	WASHER,LOCK	EA	1
16	10	PAHZZ	5365-00-453-6642	1250-0005	28480	BUSHING,MACH THREAD	EA	1
16	11	PAHZZ	6625-00-650-4953	88-35	91737	GASKET	EA	1
					<b>41</b>			



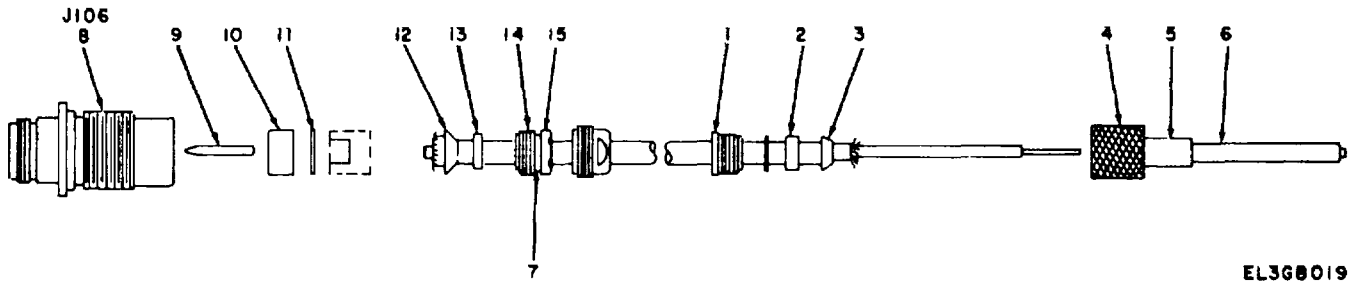
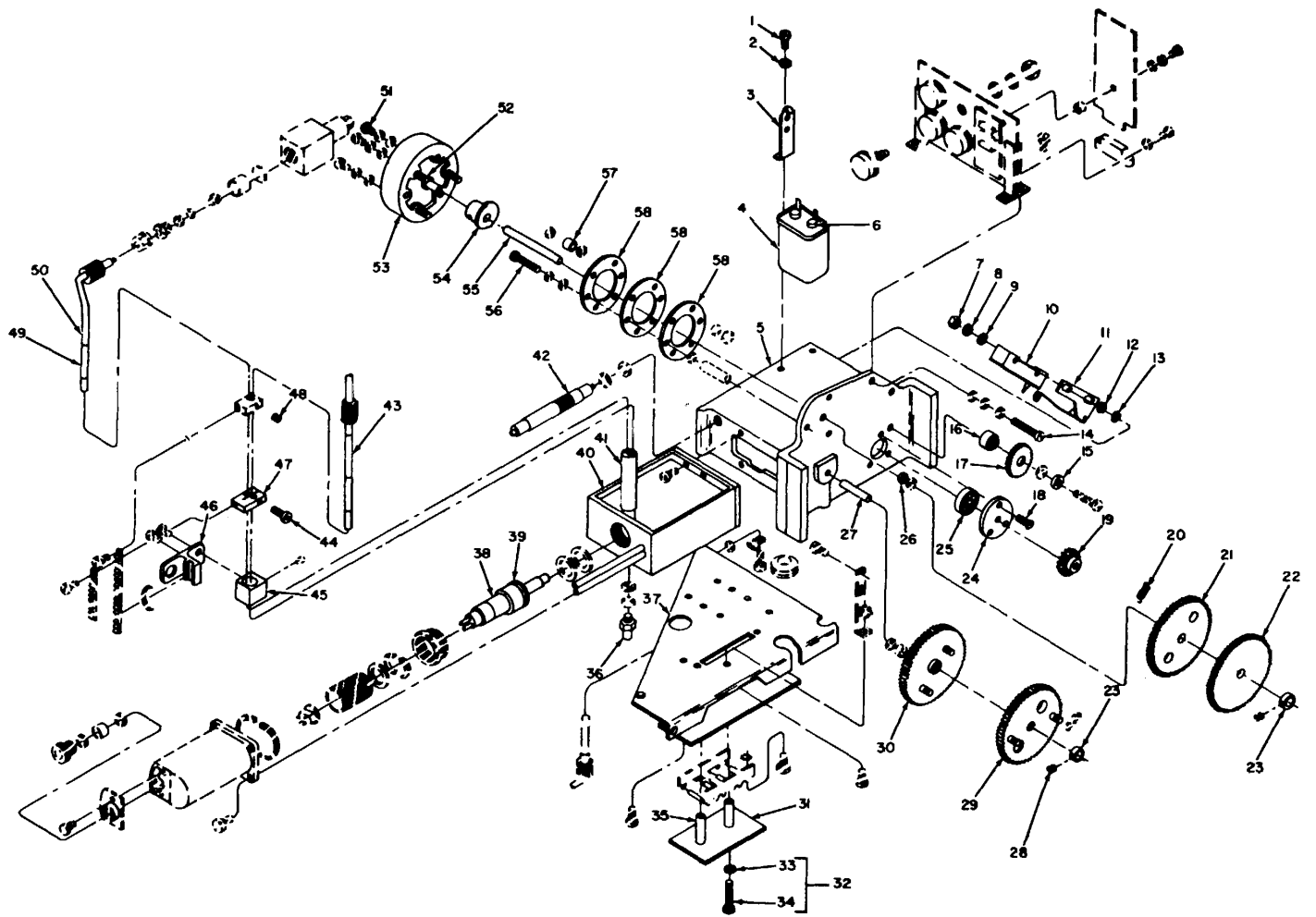

Figure 17 . Probe Assembly A2A3 .

SECTION II

TM11-6625-2520-24P

(1) ILLUSTRATION		(2)	(3)	(4)	(5)	(6) DESCRIPTION	(7)	(8)
(a) FIG NO.	(b) ITEM NO.	SMR CODE	NATIONAL STOCK NUMBER	PART NUMBER	FSCM	USABLE ON CODE	U/M	QTY INC IN UNIT
						GROUP 010203 PROBE ASSEMBLY AZA3		
17	1	PAHZZ	5365-00-45-6642	1250-0005	28480	BUSHINGS, MACH THERAD.....	EA	1
17	2	PAHZZ	6625-00-650-4953	88-35	91737	GASKET .....	EA	1
17	3	PAHZZ	5365-00-882-0401	88-28	91737	WASHER, LOCK .....	EA	1
17	4	XDHZZ			28480	BODY, CONNECTOR .....	EA	1
17	5	XDHZZ		00618-231	28480	BODY, PROBE .....	EA	1
17	6	XDHZZ		00618-2056	28480	TERMINATION, PROBE.....	EA	1
17	7	XDHZZ		1250-0006	28480	WASHER, FLAT .....	EA	1
17	8	PAHZZ	5935- 00-824-7685	1250-0144	28480	CONNECTOR,RCPT,ELEC.....	EA	1
17	9	PAHZZ	5999-00-463-9891	1250-1026	28480	CONTACT, ELECTRIC.....	EA	1
17	10	PAHZZ	5970-00-933-4602	5040-0214	28480	BEAD, CONNECTOR.....	EA	1
17	11	PAHZZ	5970 -00-933-4602	1250-0214	28480	INSULATOR, WASHER .....	EA	1
17	12	PAHZZ	5935-00-973-8288	1250-0145	28480	WASHER, CLAMP .....	EA	1
17	13	PAHZZ	5330-00-973-8288	1250-0142	28480	GASKET .....	EA	1
17	14	PAHZZ	5975-00-937-4820	1250-0142	28480	BUSHING, MACH THREAD .....	EA	1
17	15	XDHZZ		1250-0147	28480	NUT, RETAINING.....	EA	1
					<b>43</b>			



EL368020

Figure 18. Frequency Control Assembly A2A4.

SECTION II

TM11-6625-2520-24P

(1) ILLUSTRATION		(2)	(3)	(4)	(5)	(6) DESCRIPTION	(7)	(8)
(a) FIG NO.	(b) ITEM NO.	SMR CODE	NATIONAL STOCK NUMBER	PART NUMBER	FSCM	USABLE ON CODE	U/M	QTY INC IN UNIT
						GROUP 010204 FREQUENCY CONTROL ASSEMBLY A2A4		
18	1	PAHZZ	5305-00-054-6652	MS51957-28	96906	SCREW, MACHINE.....	EA	2
18	2	PAHZZ	5310-00-905-5159	MS35335-87	96906	WASHER, LOCK.....	EA	2
18	3	PAHZZ	5910-00-519-6C48	CP07FA2	81349	RETAINER, CAPACITOR.....	EA	2
18	4	PAHZZ	5910-00-797-9731	0160-0088	28480	CAPACITOR, FXD, PPR.....	EA	1
18	5	XDHZZ		618836D	28480	HOUSING, MECH DRIVE.....	EA	1
18	6	XDHZZ		618836AJ	28480	POST, ELCTRCMECH.....	EA	2
18	7	PAHZZ	5310-00-934-9761	M354649-264	96906	NUT, PLAIN, HEXAGON.....	EA	5
18	8	PAHZZ	5310-00-184-8977	MS35338-98	96906	WASHER, LOCK.....	EA	5
18	9	PAHZZ	5310-00-880-5976	MS15795-806	96906	WASHER, FLAT.....	EA	5
18	10	PAHZZ	5930-00-54-7764	BZ2RS	91929	SWITCH, SENSITIVE.....	EA	1
18	11	PAHZZ	5930-00-755s-2005	TR	91929	ACTUATOR, SWITCH.....	EA	1
18	12	PAHZZ	5310-00-939-0903	MS35335-86	96906	WASHER, LOCK.....	EA	20
18	13	PAHZZ	5310-00-843-7333	2150	83330	WASHER, NONMETALLIC.....	EA	4
18	14	PAHZZ	5305-00-95-5453	MS35190-236	96906	SCREW, MACHINE.....	EA	4
18	15	PAHZZ	53100-00-019-0670	MS35333-106	96906	WASHER, LOCK.....	EA	1
18	16	XDHZZ		608D47J	28480	SPACER, STEPPED.....	EA	1
18	17	PAHZZ	3020-00-588-0884	5020-02781	28480	GEAR, ELECTRICAL.....	EA	1
18	18	PAHZZ	5305-00-054-6658	MS51957-34	96906	SCREW, MACHINE.....	EA	5
18	19	XDHZZ	618B36AX		28480	GEAR, SPUR.....	EA	1
18	20	XDHZZ	1460-0048		28480	SPRING, HLCL EXT.....	EA	4
18	21	XDHZZ	618836N		28460	GEAR, SPUR.....	EA	1
18	22	XDHZZ	618B3AX		28480	GEAR, SPUR.....	EA	1
18	23	PAHZZ	3040-00-127 2837	5020-0233	28480	COLLAR, SHAFT.....	EA	2
18	24	XDHZZ	618B36L		28480	RETAINER, BALL BRG.....	EA	2
18	25	XDHZZ	1410-0009		28480	BEARING, BALL ANLR.....	EA	2
18	26	PAHZZ	5310-00-880-5978	MS15795-807	96906	WASHER, FLAT.....	EA	4
18	27	XDHZZ		5020-0340	28480	SHAFT.....	EA	1
18	28	PAHZZ	5305-00-054-6658	MS1957-34	96906	SCREW, MACHINE.....	EA	6
18	29	PAHZZ	3020-00-600-7082	618B36Q	28480	GEAR, SPUR.....	EA	1
18	30	PAHZZ	3020-00-600-0792	618836R	28480	GEAR, SPUR.....	EA	1
18	31	XDHZZ		00618-034	26480	SHEILD, RESISTOR.....	EA	1
18	32	XDHZZ		00618-204	28480	DRIVE, SCREW ASSY.....	E	1
18	33	PAHZZ	5305-00-054-6659	MS957-35	96906	SCREW, MACHINE.....	EA	2
18	35	XDHZZ	0380-0014		28480	SPACER, SLEEVE EA.....	EA	2
18	36	XDHZZ		00618-238	24480	ADAPTER, TUBE.....	EA	1
18	37	XDHZZ		618836AA	28480	PLATE, BACK EA.....	EA	1
18	38	PAHZZ	6625-00-877-0280	618836Z	28480	CONDUCTOR ASSY, CTC.....	EA	1
					45			

(1) ILLUSTRATION		(2)	(3)	(4)	(5)	(6) DESCRIPTION	(7)	(8)
(a) FIG NO.	(b) ITEM NO.	SMR CODE	NATIONAL STOCK NUMBER	PART NUMBER	FSCM	USABLE ON CODE	U/M	QTY INC IN UNIT
18	39	XDHZZ		618836AK	28480	FILTER RPLR ASSY	EA	1
18	40	XDHHH		00618-2061	28480	CAVITY, CONTROL ASSY	EA	1
18	41	XDHZZ		00618-2059	28480	TUBE, ATTENUATOR	EA	1
18	42	PAHZZ	5915-00-793-022	61827	28480	FILTER, LOW PASS	EA	1
18	43	PAHZZ	5340-00-470-072	618836BC	28480	PLUNGER ASSEMBLY	EA	1
18	44	PAHZZ	5305-00-987-760	MS16995-27	96906	SCREW, CAP SKY HEAD	EA	1
18	45	XDHZZ		61883A	28480	GUIDE, RETSAINER	EA	1
18	46	XDHZZ		618836AD	28480	RAR, GUIDE	EA	1
18	47	XDHZZ		620A28C	28480	STOP, PROBE	EA	1
18	48	PAHZZ	5305-00-071-132	MS51960-65	96906	SCREW, MACHINE	EA	1
18	49	XDHZZ		00618-226	28480	PROBE, BOLOMETER	EA	1
18	50	XDHZZ		61836G	28480	BAR, PLUNGER	EA	1
18	51	PAHZZ	5305-00-057-052	MS5195-28	96906	SCREW MACHINE	EA	2
18	52	PAHZZ	5305-00-054-666	MS51957-37	96906	SCREW MACHINE	EA	8
18	53	PAHZZ	5305-00-835-8861	2100-0127	28480	RESISTOR,VAR WW	EA	1
18	54	XDHZZ		00618-242	28480	COUPLER,POT	EA	1
18	55	XDHZZ		5020-0349	28480	SHAFT	EA	1
18	56	XDHZZ		4233	73734	SCREW MACHINE	EA	3
18	57	XDHZZ		618836AE	28480	SPACER,SLEEVE	EA	3
18	58	XDHZZ		618836AT	28480	PLATE,MOUNTING	EA	3
<b>46/(47 blank)</b>								

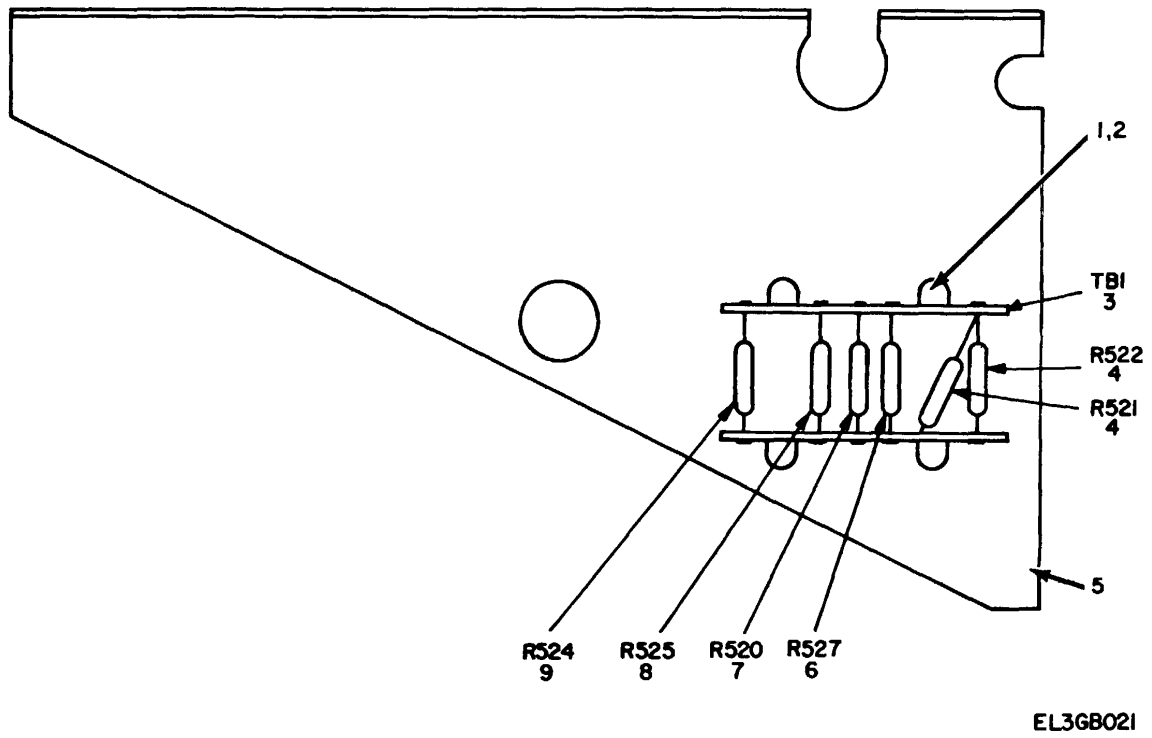

Figure 19. Divider Assembly A2AS.

SECTION II

TM11-6625-2520-24P

(1) ILLUSTRATION		(2)	(3)	(4)	(5)	(6) DESCRIPTION	(7)	(8)
(a) FIG NO.	(b) ITEM NO.	SMR CODE	NATIONAL STOCK NUMBER	PART NUMBER	FSCM	USABLE ON CODE	U/M	QTY INC IN UNIT
						GROUP 010205 DIVIDER ASSEMBLY A2A5		
19	1	PAHZZ	5305-00-054-6668	MS51957-43	96906	SCREW, MACHINE	EA	4
19	2	PAHZZ	5310-00-905-5159	MS35335-87	96906	WASHER, LOCK	EA	4
19	3	PAHZZ	5940-00-105-6337	332-14-07-183	19701	TERMINAL BOARD	EA	1
19	4	PAHZZ	5905-00-932-6822	MF7CD1104F	19701	RESISTOR, FXD, FILM	EA	2
19	5	XDHZZ		00618-0041	28480	BRACKET, SUPPORT	EA	1
19	6	PAHZZ	5905-00-994-8550	MF7CD4643F	19701	RESISTOR, FXD, FILM	EA	1
19	7	PAHZZ	5905-00-057-8483	MF7CD8253F	19701	RESISTOR, FXD, FILM	EA	1
19	8	PAHZZ	5905-00-994-8531	MF7CD1004F	19701	RESISTOR, FXD, FILM	EA	1
19	9	PAHZZ	5905-00-994-8548	MF7CD3833F	19701	RESISTOR, FXD, FILM	EA	1
					<b>49</b>			

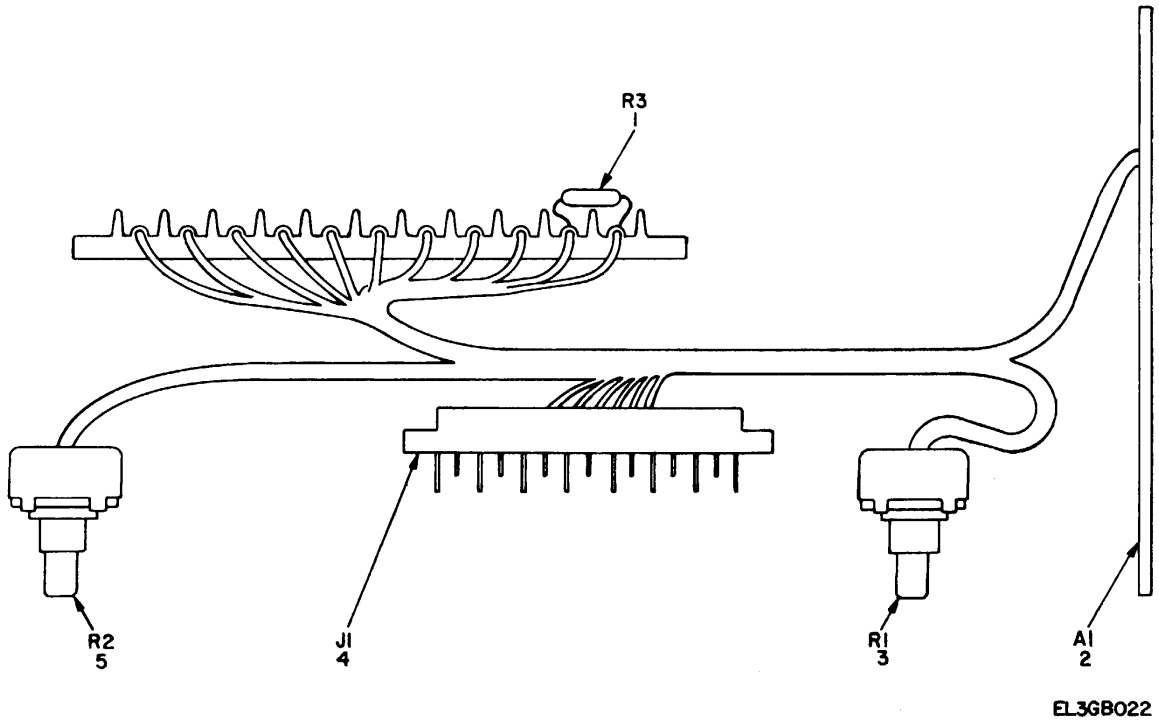

Figure 20. Wiring Harness A2W1.



SECTION II

TM11-6625-2520-24P

(1) ILLUSTRATION		(2)	(3)	(4)	(5)	(6)	(7)	(8)
(a) FIG NO.	(b) ITEM NO.	SMR CODE	NATIONAL STOCK NUMBER	PART NUMBER	FSCM	DESCRIPTION  USABLE ON CODE	U/M	QTY INC IN UNIT
						GROUP 010206 WIRING HARNESS A2W1		
20	1	PAHZZ	5905-00-994-8531	MF7CD1004F	19701	RESISTOR,FXD,FILM	EA	1
20	2	XDHHH		00618-643	28480	RESISTOR BOARD ASSY	EA	1
20	3	PAHZZ	5905-00-829-2827	2100-0047	28480	RESISTOR,VARIABLE	EA	1
20	4	XDHZZ		91-6006-5500-00	95354	CONNECTOR,PLUG,ELEC	EA	1
20	5	PAHZZ	5905-00-172-0855	2100-0465	28480	RESISTOR,VARIABLE	EA	1
					<b>51</b>			

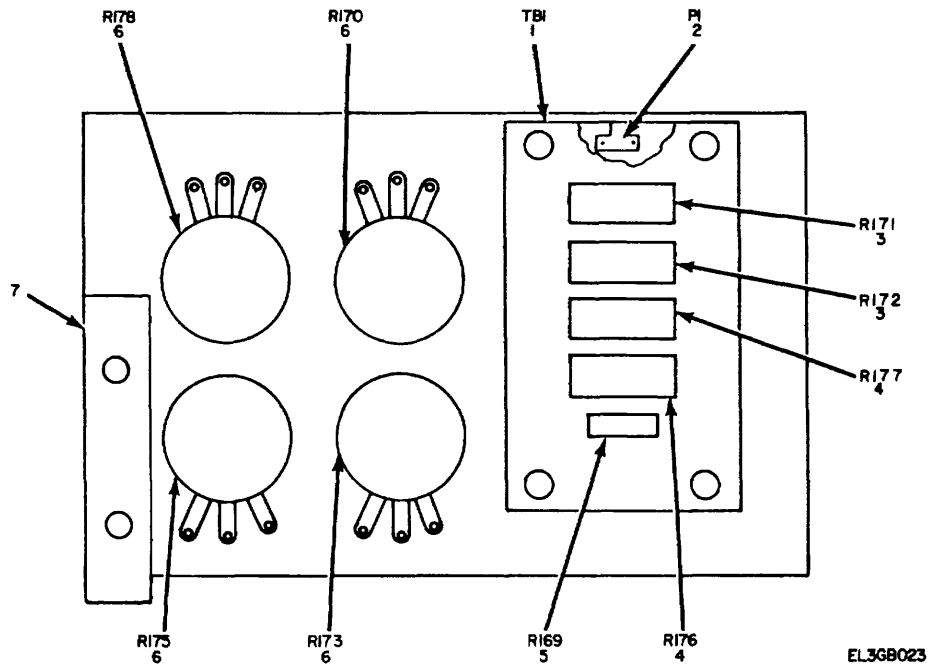

Figure 21. Resistor Board Assembly A2W11A1.

SECTION II

TM11-6625-2520-24P

(1) ILLUSTRATION		(2)	(3)	(4)	(5)	(6) DESCRIPTION	(7)	(8)
(a) FIG NO.	(b) ITEM NO.	SMR CODE	NATIONAL STOCK NUMBER	PART NUMBER	FSCM	USABLE ON CODE	U/M	QTY INC IN UNIT
						GROUP 01020601 RESISTOR BOARD ASSEMBLY A2W1A1		
21	1	XDHZZ		354-17-11-001	71785	TERMINAL BOARD	EA	1
21	2	XDHZZ		91-6006-5500-00	95354	CONNECTOR, PLUG, ELEC	EA	1
21	3	PAHZZ	5905-00-650-9808	RCR42G682JS	81349	RESISTOR, FXD, COMP	EA	2
21	4	PAHZZ	5905-00-767-0944	RCR42G472JS	81349	RESISTOR, FXD, COMP	EA	2
21	5	PAHZZ	5905-00-106-1276	RCR32G104JS	81349	RESISTOR, VARIABLE	EA	1
21	6	PAHZZ	5905-00-812-6400	2100-0028	28480	RESISTOR, VARIABLE	EA	4
21	7	XDHZZ		5000-0221	28480	BRACKET, ANGLE	EA	4
					<b>53</b>			

REF. DEF.	ITEM NO.
C360	1
C361	1
C364	2
C366	2
CR301	3
CR302	3
R360	4
R361	5
R362	5
R363	6
R364	7
R365	6
R366	7
R367	5
R368	8
R369	9
R370	9
R371	10
R372	11
R373	12
R374	13
R375	14
R377	15
R379	16

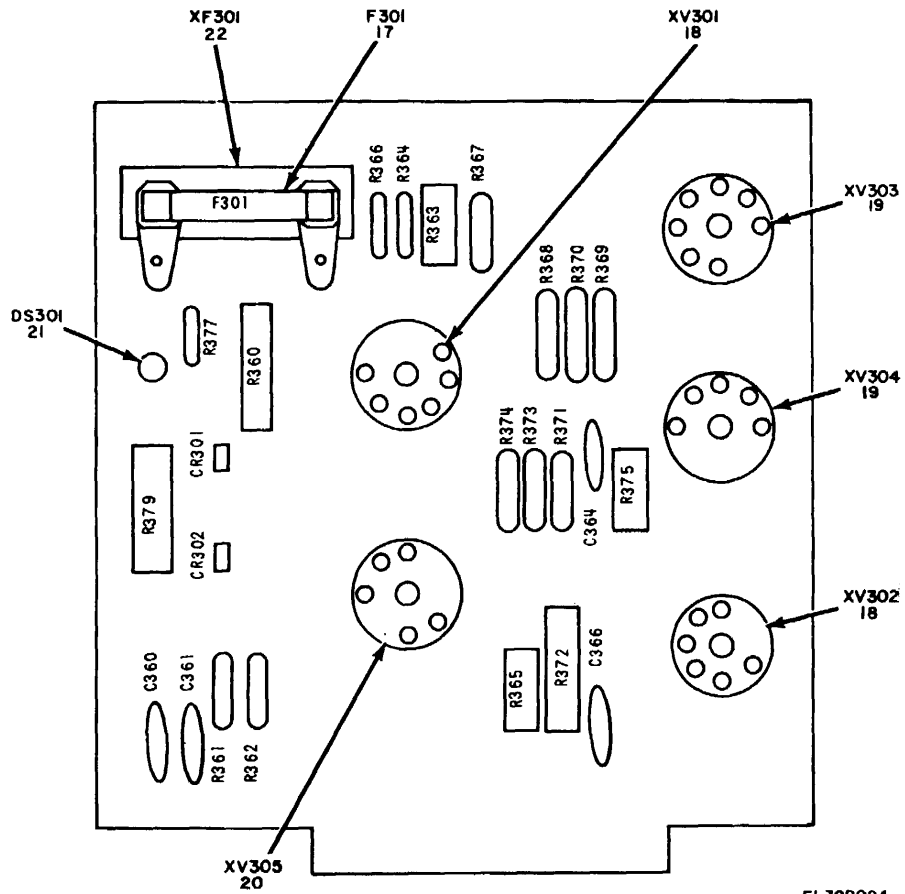
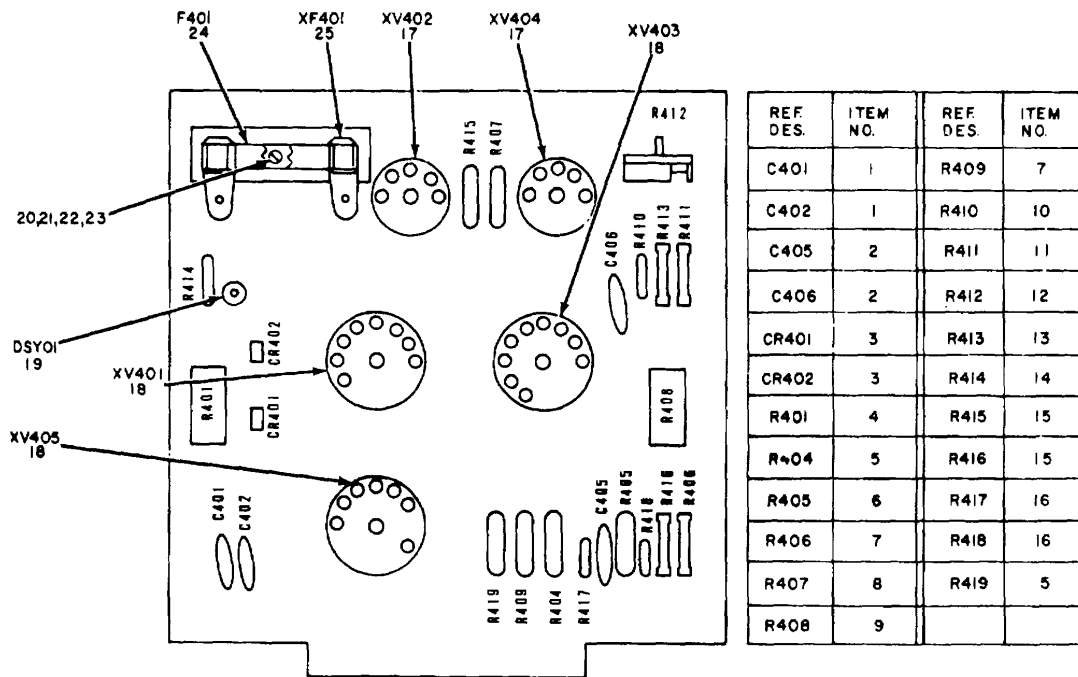

Figure 22. Circuit Card Assembly A300.

SECTION II

TM11-6625-2520-24P

(1) ILLUSTRATION		(2)	(3)	(4)	(5)	(6) DESCRIPTION	(7)	(8)
(a) FIG NO.	(b) ITEM NO.	SMR CODE	NATIONAL STOCK NUMBER	PART NUMBER	FSCM	USABLE ON CODE	U/M	QTY INC IN UNIT
						GROUP 010207 CIRCUIT CARD ASSEMBLY A300		
22	1	PAHZZ	5910-00-851-7794	29C214A3	56289	CAPACITOR,FXD,CER.....	EA	2
22	2	PAHZZ	5910-00-797-4909	5GAS50	56289	CAPACITOR,FXD,CER.....	EA	2
22	3	PAHZZ	5961-00-950-0537	1901-0029	28480	SEMICONDUCTOR,DIODE.....	EA	2
22	4	PAHZZ	5905-00-927-8485	243E2005	56289	RESISTOR,FXD,WW.....	EA	1
22	5	PAHZZ	5905-00-079-3197	RN60D4753F	81349	RESISTOR,FXD,FILM.....	EA	3
22	6	PAHZZ	5905-00-141-1149	RCR32G391JS	81349	RESISTOR,FXD,COMP.....	EA	2
22	7	PAHZZ	5905-00-043-0381	RN60D2211F	81349	RESISTOR,FXD,FILM.....	EA	2
22	8	PAHZZ	5905-00-994-8537	MF7CD1503F	19701	RESISTOR,FXD,FILM.....	EA	1
22	9	PAHZZ	5905-00-994-8545	MF7CD2743F	19701	RESISTOR,FXD,FILM.....	EA	2
22	10	PAHZZ	5905-00-213-6141	MF7CD1214F	19701	RESISTOR,FXD,FILM.....	EA	1
22	11	PAHZZ	5905-00-240-4551	0811-0007	28480	RESISTOR,FXD,WW.....	EA	1
22	12	PAHZZ	5905-00-456-5251	MF7CD1504F	19701	RESISTOR,FXD,FILM.....	EA	1
22	13	XDHZZ		MF7CD1304F	19701	RESISTOR,FXD,FILM.....	EA	1
22	14	PAHIZ	5905-00-II-6009	RCR32G84JS	81349	RESISTOR,FXD,COMP.....	EA	1
22	15	PAHZZ	5905-00-984-7679	RN60D1213F	81349	RESISTOR,FXD,FILM.....	EA	1
22	16	PAHZZ	5905-00-492-6670	0812-0038	28480	RESISTOR,FXD,WW.....	EA	1
22	17	PAHZZ	5920-00-199-9498	313-500	75915	FUSE,CARTRIDGE.....	EA	1
22	18	PAHZZ	5935-00-918-4391	5040-0417	28480	RETAINER,TUBE SKT.....	EA	2
22	19	PAHZZ	5935-00-808-9569	121-51-11-060	71785	SOCKET,ELECTRN TUBE.....	EA	2
22	20	PAHZZ	5935-00-856-6987	111-51-11-069	71785	SOCKET, ELECTRN TUBE.....	EA	1
22	21	PAHZZ	6240-00-912-5186	A1C	08108	LAMP,GLOW.....	EA	1
22	22	PAHZZ	5920-00-804-9688	1400-0008	28480	FUSEHOLDER.....	EA	1
					<b>55</b>			



EL368025

Figure 23. Circuit Card Assembly A400.

## SECTION II

TM11-6625-2520-24P

(1) ILLUSTRATION		(2)	(3)	(4)	(5)	(6) DESCRIPTION	(7)	(8)
(a) FIG NO.	(b) ITEM NO.	SMR CODE	NATIONAL STOCK NUMBER	PART NUMBER	FSCM	USABLE ON CODE	U/M	QTY INC IN UNIT
						GROUP 010208 CIRCUIT CARD ASSEMBLY A400		
23	1	PAHZZ	5910-00-851-7794	292C214A3	56289	CAPACITOR,FXD,CER	EA	2
23	2	PAHZZ	5910-00-797-4909	5GAS50	56289	CAPACITOR,FXD,CER	EA	2
23	3	PAHZZ	5961-00-902-7499	1N3958	80131	SEMICONDUCTOR,DIODE	EA	2
23	4	PAHZZ	5905-00-156-0435	RCR42G390JS	81349	RESISTOR,FXD,COMP	EA	1
23	5	PAHZZ	5905-00-917-4149	MF7CD2213F	19701	RESISTOR,FXD,FILM	EA	2
23	6	PAHZZ	5905-00-069-3922	RN60D6812F	81349	RESISTOR,FXD,FILM	EA	1
23	7	PAHZZ	5905-00-456-5251	MF7CD1504F	19701	RESISTOR,FXD,FILM	EA	2
23	8	PAHZZ	5905-00-057-8468	MF7CD5622F	19701	RESISTOR,FXD,FILM	EA	1
23	9	PAHZZ	5905-00-422-4129	RCR42G224JS	81349	RESISTOR,FXD,COMP	EA	1
23	10	PAHZZ	5905-00-079-3197	RN60D4753F	81349	RESISTOR,FXD,FILM	EA	1
23	11	PAHZZ	5905-00-989-9546	MF7CD1103F	19701	RESISTOR,FXD,FILM	EA	1
23	12	PAHZZ	5905-00-050-7071	2100-1472	28480	RESISTOR,VARIABLE	EA	1
23	13	PAHZZ	5905-00-057-8433	MF7CD8253F	19701	RESISTOR,,FXD,FILM	EA	1
23	14	PAHZZ	5905-00-984-7679	RN60D1213F	81349	RESISTOR,FXD,FILM	EA	1
23	15	PAHZZ	5905-00-057-8480	MF7CD51R1F	19701	RESISTOR,FXD,FILM	EA	2
23	16	PAHZZ	5905-00-965-9051	RN55D2001F	81349	RESISTOR,FXD,FILM	EA	2
23	17	PAHZZ	5935-00-478-7535	05-0730-02	91662	SOCKET,ELCTR N TUBE	EA	2
23	18	PAHZZ	5935-00-483-3979	05-0930-02	91662	SOCKET,ELCTR N TUBE	EA	3
23	19	PAHZZ	6240-00-912-5186	ATC	08108	LAMP,GLOW	EA	1
23	20	PAHZZ	5305-00-057-0526	MS51958-30	96906	SCREW,MACHINE	EA	1
23	21	PAHZZ	5310-00-880-5976	MS15795-806	96906	WASHER,FLAT	EA	1
23	22	PAHZZ	5310-00-939-0903	MS35335-86	96906	WASHER,LOCK	EA	1
23	23	PAHZZ	5310-00-934-9761	MS35649-264	96906	NUT,PLAIN,HEXAGON	EA	1
23	24	PAHZZ	5920-00-199-9498	313-500	75915	FUSE,CARTRIDGE	EA	1
23	25	PAHZZ	5920-00-804-9688	1400-0008	28480	FUSEHOLDER	EA	1
					<b>57</b>			

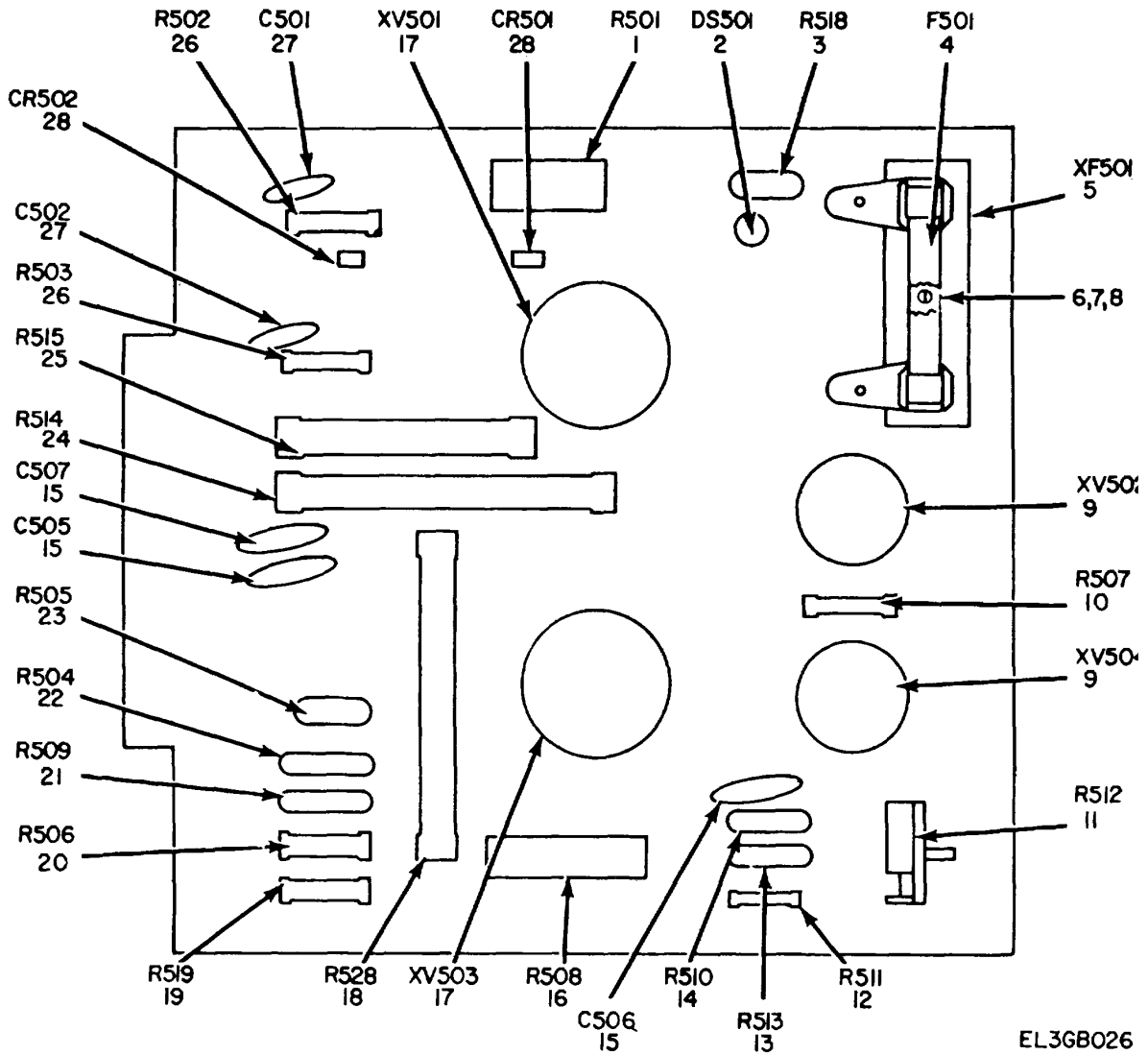

Figure 24. Circuit Card Assembly A500.



## SECTION II

TM11-6625-2520-24P

(1) ILLUSTRATION		(2)	(3)	(4)	(5)	(6) DESCRIPTION	(7)	(8)
(a) FIG NO.	(b) ITEM NO.	SMR CODE	NATIONAL STOCK NUMBER	PART NUMBER	FSCM	USABLE ON CODE	U/M	QTY INC IN UNIT
						GROUP 010209 CIRCUIT CARD ASSEMBLLY A500		
24	1	PAHZZ	5905-00-477-1201	RCR42G70JS	81349	RESISTOR,FXD,FILM	EA	1
24	2	PAHZZ	6240-00-912-5186	A1C	08108	LAMP,GLOW	EA	1
24	3	PAHZZ	5905-00-930-7956	MF7CD1003F	19701	RESISTOR,FXD,FILM	EA	1
24	4	PAHZZ	5920-00-280-8344	312-500	75915	FUSE,CARTRIDGE	EA	1
24	5	PAHZZ	5920-00-804-9688	1400-008	28480	FUSEHOLDER	EA	1
24	6	PAHZZ	5305-00-057-0526	MS5198-30	96906	SCREW MACHINE	EA	1
24	7	PAHZZ	5310-00-880-5976	MS51795-806	96906	WASHER,FLAT	EA	1
24	8	PAHZZ	5310-00-934-9761	MS35649-264	96906	NUT,PLAIN,HEXAGON	EA	1
24	9	PAHZZ	5935-00-478-7535	05-0730-02	91662	SOCKET,ELETRN TUBE	EA	2
24	10	PAHZZ	5905-00-057-8468	MF7CD5622F	19701	RESISTOR,FXD,FILM	EA	1
24	11	PAHZZ	5905-00-050-7071	2100-1472	28480	RESISTOR,VARIABLE	EA	1
24	12	PAHZZ	5905-00-984-7679	RN60D1213F	81349	RESISTOR,FXD,FILM	EA	1
24	13	PAHZZ	5905-00-067-5576	RN60D6813F	81349	RESISTOR,FXD,FILM	EA	1
24	14	PAHXZZ	5905-00-079-3197	RN60D4753F	81349	RESISTOR,FXD,FILM	EA	1
24	15	PAHZZ	5910-00-797-4909	5GAS50	56289	CAPACITOR,FXD,CER	EA	3
24	16	XDHZZ		MF8CC8203F	19701	RESISTOR,FXD,FILM	EA	1
24	17	PAHZZ	5935-00-483-3979	05-0930-02	91622	SOCKET,ELCTR N TUBE	EA	2
24	18	PAHZZ	5905-00-172-0854	FP7-4702K	16299	RESISTOR,FXD,FILM	EA	1
24	19	[PAHZZ	5905-00-213-6141	MF7CD1214F	19701	RESISTOR,FXD,FILM	EA	1
24	20	PAHZZ	5905-00-456-5251	MF7CD1504F	19701	RESISTOR,FXD,FILM	EA	1
24	21	XDHZZ		MF7CD1304F	19701	RESISTOR,FXD,FILM	EA	1
24	22	PAHZZ	5905-00-927-2876	MNF7CD3923F	19701	RESISTOR,FXD,FILM	EA	1
24	23	PAHZZ	5905-00-069-3922	RN60D6812F	81349	RESISTOR,FXD,FILM	EA	1
24	24	XDHZZ		LP1-7-7502K	16299	RESISTOR,FXD,FILM	EA	1
24	25	PAHZZ	5905-00-894-3407	FP4-3002K	16299	RESISTOR,FXD,FILM	EA	1
24	26	PAHZZ	5905-00-994-8553	MF7CD4753F	19701	RESISTOR,FXD,FILM	EA	2
24	27	PAHZZ	5820-00-144-8083	A3	06178	COMPRESSOR,DYHR	EA	2
24	28	PAHZZ	5961-00-921-3778	1901-0036	28480	SEMICONDUCTOR,DIODE	EA	2
					<b>59</b>			

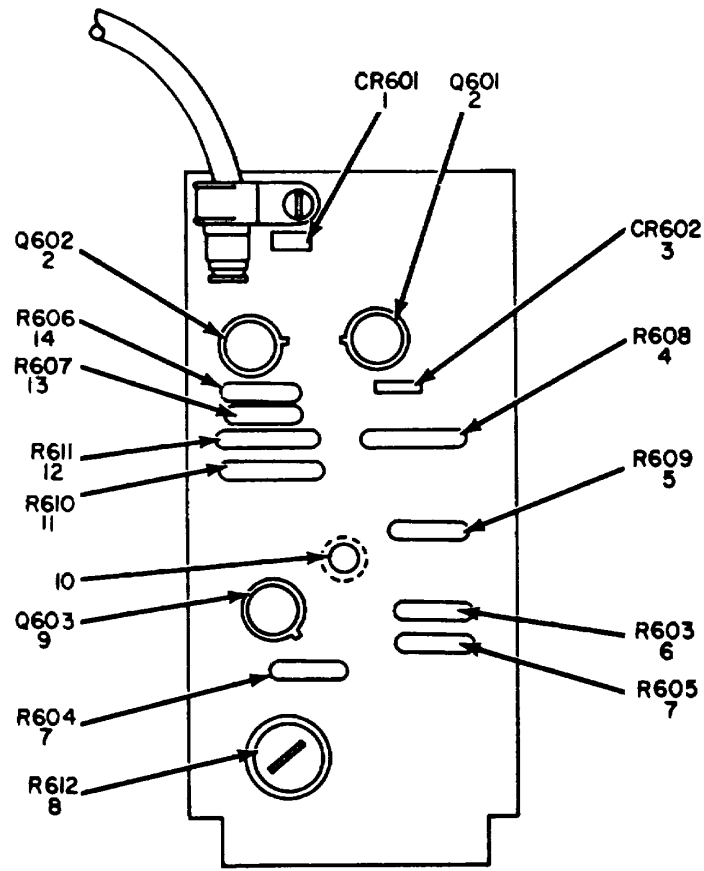

EL3GB027

Figure 25. Circuit Card Assembly A600.

SECTION II

TM11-6625-2520-24P

(1) ILLUSTRATION		(2)	(3)	(4)	(5)	(6) DESCRIPTION	(7)	(8)
(a) FIG NO.	(b) ITEM NO.	SMR CODE	NATIONAL STOCK NUMBER	PART NUMBER	FSCM	USABLE ON CODE	U/M	QTY INC IN UNIT
						GROUP 010210 CIRCUIT CARD ASSEMBLY A600		
25	1	PAHZZ	5961-00-821-2309	JAN1N751A	81349	SEMICONDUCTOR,DIODE .....	EA	1
25	2	PAHZZ	5961-00-836-1887	1854-0221	28480	TRANSISTOR.....	EA	2
25	3	PAHZZ	5961-00-978 7468	1901-0025	28480	SEMICONDUCTOR,DIODE .....	EA	1
25	4	PAHZZ	5905-00-994-8537	MF7CD1503F	19701	RESISTOR,FXD,FILM .....	EA	1
25	5	PAHZZ	5905-00-965-9049	RN55D2002F	81349	RESISTOR,FXD,FILM .....	EA	1
25	6	PAHZZ	5905-00-728-1659	RN55D1501F	81349	RESISTOR,FXD,FILM .....	EA	1
25	7	PAHZZ	5905-00-068-4287	RN55D4751F	81349	RESISTOR,FXD,FILM .....	EA	2
25	8	PAHZZ	5905-00-891-4221	2100-0898	28480	RESISTOR,VARIABLE.....	EA	1
25	9	PAHZZ	5961-00-990-5369	1854-0003	28480	TRANSISTOR.....	EA	1
25	10	PAHZZ	5365-00-161-9382	0380-0114	28480	SPACER,SLEEVE.....	EA	1
25	11	PAHZZ	5905-00-917-4149	MF7CD2213F	19701	RESISTOR,FXD,FILM .....	EA	1
25	12	PAHZZ	5905-00-057-8403	MF7CD1303F	19701	RESISTOR,FXD,FILM .....	EA	1
25	13	PAHZZ	5905-00-734-4083	RN55D2432F	81349	RESISTOR,FXD,FILM .....	EA	1
25	14	PAHZZ	5905-00-889-0226	RN55D6811F	81349	RESISTOR,FXD,FILM .....	EA	1
					<b>61</b>			

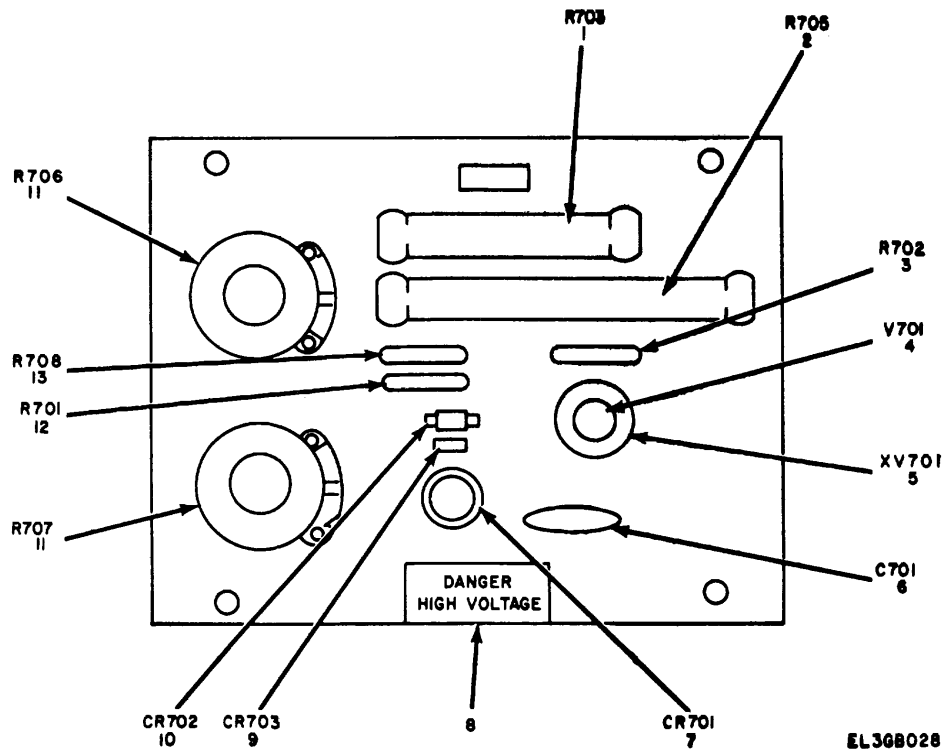

Figure 26. Circuit Card Assembly A700.

SECTION II

TM11-6625-2520-24P

(1) ILLUSTRATION		(2)	(3)	(4)	(5)	(6) DESCRIPTION	(7)	(8)
(a) FIG NO.	(b) ITEM NO.	SMR CODE	NATIONAL STOCK NUMBER	PART NUMBER	FSCM	USABLE ON CODE	U/M	QTY INC IN UNIT
						GROUP 010211 CIRCUIT CARD ASSEMBLY A700		
26	1	PAHZZ	5905-00-208-4340	FP4-240K	16299	RESISTOR,FXD,FILM.....	EA	1
26	2	PAHZZ	5905-00-213-6131	FP7-7502K	16299	RESISTOR,FXD,FILM.....	EA	1
26	3	PAHZZ	5905-00-994-8544	MF7CD2433F	16299	RESISTOR,FXD,FILM.....	EA	1
26	4	PAHZZ	5960-00-958-073	7895	81349	ELECTRON TUBE.....	EA	1
26	5	PAHZZ	5935-00-945-9824	133-65-11-026	71785	SOCKET,ELCTR N TUBE .....	EA	1
26	6	PAHZZ	5910-00-854-7130	30GAS10	56289	CAPACITOR,FXD CER.....	EA	1
26	7	PAHZZ	5961-00-931-0286	1902-0241	28480	SEMICONDUCTOR,DIODE .....	EA	1
26	8	XDHZZ		00618-2057	28480	PLATE,IDENT .....	EA	1
26	9	PAHZZ	5961-00-938-5641	1N629	80131	SEMICONDUCTOR,DIODE .....	EA	1
26	10	PAHZZ	5961-00-060-8636	1901-0026	28480	SEMICONDUCTOR,DIODE .....	EA	1
26	11	PAHZZ	5905-00-172-0856	2100-2154	28480	RESISTOR,VARIABLE.....	EA	2
26	12	PAHZZ	5905-00-932-6822	MF7CD1104F	19701	RESISTOR,FXD,FILM.....	EA	1
26	13	PAHZZ	5905-00-994-8548	MF7CD383F	19701	RESISTOR,FXD,FILM.....	EA	1
					<b>63</b>			

## SECTION IV

TM11-625-2520-24P

## NATIONAL STOCK NUMBER AND PART NUMBER INDEX

NOTE: LATEST NATIONAL STOCK NUMBER AND PART NUMBER ASSIGNMENTS ARE INCLUDED AT END OF INDEX

STOCK NUMBER	FIGURE NO..	ITEM NO.	STOCK NUMBER	FIGURE NO.	ITEM NO.
5905-00-001-3031	11	23	5905-00-111-8372	10	15
5310-00-019-0070	18	15	5910-00-112-7117	7	40
4140-00-009-4686	2	35	5905-00-113-4850	10	24
5905-00-023-4837	7	15	5905-00-113-4850	11	15
5960-00-027-1728	2	23	5935-00-113-5091	2	8
3020-00-031-1018	15	11	5120-00-116-7985	2	18
3020-00-031-1019	15	23	5310-00-125-6170	6	4
6625-00-034-6690	15	14	3040-00-127-2837	15	1
5905-00-043-0381	22	7	3040-00-127-2837	18	23
3110-00-044-4155	15	22	5905-00-133-0379	10	21
5310-00-045-3296	3	5	5960-00-134-6012	7	13
5310-00-045-3296	4	17	5960-00-134-9919	7	8
5905-00-050-7071	23	12	5995-00-139-5716	7	23
5905-00-050-7071	24	11	5995-00-139-5787	7	24
5305-00-050-9232	2	26	5905-00-141-1071	3	13
5305-00-054-5636	13	30	5905-00-141-1149	22	6
5305-00-054-5646	14	22	5820-00-144-8083	24	27
5305-00-054-5648	3	72	5365-00-150-4945	4	19
5305-00-054-5651	14	25	5905-00-152-8373	11	19
5305-00-054-6652	18		5905-00-156-0435	23	4
5305-00-054-6658	18	18	5355-00-156-6559	2	36
5305-00-054-6658	18	28	5355-00-156-6559	4	21
5305-00-054-6659	18	34	5365-00-161-9382	25	10
5305-00-054-6661	18	52	5905-00-172-0854	24	18
5305-00-054-6662	2	10	5905-00-172-0855	20	5
5305-00-054-6668	6	5	5905-00-172-0856	26	11
5305-00-054-6668	7	36	5905-00-184-7703	10	11
5305-00-054-6668	19	1	5905-00-184-7703	11	24
5305-00-054-6670	3	4	5310-00-184-8977	2	28
5950-00-056-0131	2	32	5310-00-184-8917	18	8
5305-00-057-0523	4	13	5310-00-184-8977	18	33
5305-00-057-0523	7	3			
5305-00-057-0524	S	3	5920-00-199-949B	22	17
5305-00-057-0524	7	20	5920-00-199-9498	23	24
5305-00-057-0524	14	8	5365-00-203-0375	14	3
5305-00-057-0524	18	51	5930-00-205-9816	9	1
5305-00-057-0526	3	9	6625-00-207-9967	12	1
5305-00-057-0526	14	16	6625-00-207-9969	7	22
5305-00-057-0526	23	20	5905-00-208-4340	26	1
5305-00-057-0526	24	6	6625-00-213-2625	2	30
5905-00-057-8468	23	8	6625-00-213-2633	7	22
5905-00-057-8468	24	10	5905-00-213-6131	26	2
5905-00-007-8480	23	15	5905-00-213-6141	22	10
5905-00-057-8483	19	7	5905-00-213-6141	24	19
5905-00-057-8483	23	13	5930-00-219-5785	6	1
5905-00-057-8495	25	12	5930-00-2L9-5785	7	30
5961-00-060-8638	2	29	5905-00-222-2144	10	18
5961-00-060-8638	26	10	5905-00-222-2144	11	30
5905-00-067-5576	24	13	5935-00-233-6728	3	15
3100-00-068-0067	15	23	5905-00-235-3534	11	22
5905-00-068-4287	25	7	5905-00-240-4551	22	11
5905-00-069-3922	23	6	5905-00-244-7911	10	23
5905-00-069-3922	24	23	5905-00-247-8684	10	19
5305-00-071-1322	18	48	5905-00-247-8684	10	21
5905-00-079-3197	22	5	5905-00-247-8700	11	33
5905-00-079-3197	23	10	5905-00-247-8722	11	3t
5905-00-079-3197	24	14	5905-00-247-8733	10	26
5910-00-085-0438	11	9	5905-00-247-8749	10	27
5910-00-087-3522	3	11	5905-00-252-1047	10	13
5910-00-087-6816	3	12	S905-00-252-1047	11	29
5960-00-088-6527	2	24	5905-00-252-1050	10	9
3120-00-097-5004	15	10	5935-00-257-7154	3	20
5905-00-104-8347	11	34	5935-00-257-9879	2	6
5905-00-104-8351	10	12	5935-00-259-2039	2	5
5905-00-104-8351	11	32	5960-00-262-0286	2	14
5905-00-104-8353	10	22	5960-r0-269-3691	2	13
5905-00-104-8353	11	25	5960-00-269-3726	3	21
5940-00-105-6337	2	3	5920-00-280-8344	24	4
5940-00-105-6337	19	3	5910-00-329-4801	11	5
5905-00-106-1245	11	26	6150-00-351-3405	2	1
5905-00-106-1276	10	20	5905-00-369-6916	10	10
5905-00-106-1276	11	18	5905-00-369-6916	11	27
5905-00-106-1276	21	5	590-00-369-6929	10	17
5905-00-106-9344	7	16	5905-00-369-6929	11	17
5905-00-106-9346	10	25	4920-00-382-9486	15	33
5505-00-106-9346	11	28	5960-00-367-6261	14	10
5905-00-106-9353	10	16	5905-00-400-4510	10	14
5905-00-106-9353	11	20	5355-00-401-3243	13	26
5905-00-111-6009	11	14	5355-00-401-3244	13	29
5935-00-111-6192	17	10	6625-00-406-438	14	28

## NATIONAL STOCK NUMBER AND PART NUMBER INDEX

STOCK NUMBER	FIGURE NO	ITEM NO	STOCK NUMBER	FIGURE NO	ITEM NO
5915-00-421-6425	3	14	5995-00-828-9167	7	26
5905-00-422-4129	23	9	5905-00-829-2827	7	32
6625-00-445-6775	13	19	5905-00-829-2827	20	3
5365-00-453-6642	16	10	3020-00-831-5994	15	3
5165-00-453-6642	17	1	5985-00-833-2427	14	17
5365-00-453-6650	8	2	5905-00-835-8861	18	53
5905-00-456-525L	22	12	5961-00-836-1887	25	2
5905-00-456-5251	23	7	5310-00-843-7333	18	13
5905-00-456-5251	24	20	5910-00-851-7794	22	1
5910-00-463-5949	10	5	5910-00-851-7794	23	1
5510-00-463-5949	11	6	5910-00-854-7130	9	2
5599-00-463-9891	17	9	5910-00-854-7130	26	6
5340-00-470-0726	18	43	5935-00-856-6987	22	20
5930-00-476-9679	3	23	5905-00-856-8688	7	34
5905-00-477-1201	24	1	5305-00-860-1749	15	13
S935-00-478-7535	23	17	5905-00-874-0147	11	16
5935-00-478-7535	24	9	5905-00-875-4363	2	4
5935-00-483-3979	23	18	6625-00-877-0280	18	38
5935-00-483-3979	24	17	5310-00-880-5976	18	9
5905-00-492-6670	22	16	5310-00-880-5976	23	21
5910-00-519-6048	18	3	5310-00-880-5976	24	7
5960-00-537-4737	7	11	5310-00-880-5978	2	11
5920-00-536-3494	3	16	5310-00-880-5978	4	7
5355-00-543-0066	13	22	5310-00-880-5978	4	15
5310-00-543-2410	14	26	5310-00-880-5978	18	26
5910-00-544-6742	11	3	5365-00-882-040 1	6	9
5355-00-547-7996	13	3	5365-00-882-0401	17	3
5930-00-548-7764	18	10	5999-00-882-6993	8	1
5960-00-552-0082	7	10	5910-00-883-6281	10	2
5960-00-557-6780	2	16	5910-00-883-6281	11	10
5355-00-579-2318	13	14	5355-00-883-8579	3	3
3020-00-588-0884	18	17	5905-00-889-0226	25	14
3020-00-589-9680	15	24	5905-00-891-4221	25	8
3020-00-593-5141	15	2	5910-00-891-4245	11	13
6625-00-594-0458	15	9	5905-00-894-3407	24	25
3020-00-594-0557	15	18	3040-00-898-1548	14	2
3020-00-594-0555	15	29	5905-00-899-8779	7	28
3020-00-600-0792	18	30	5961-00-902-7499	23	3
3020-00-600-0794	15	19	5961-00-904-0296	10	7
3020-00-600-7082	15	20	5310-00-905-5159	6	6
3020-00-600-7082	18	29	5310-00-905-5159	7	37
3020-00-600-7084	15	31	5310-00-905-5159	13	11
5960-00-615-5584	7	17	5310-00-905-5159	14	30
5360-00-624-8953	14	12	5310-00-905-5159	18	2
5355-00-646-4704	13	9	5310-00-905-5159	19	2
6625-00-650-4953	16	11	5310-00-905-9862	3	10
6625-00-650-4953	17	2	6240-00-912-5186	22	21
5905-00-650-9808	21	3	6240-00-912-5186	23	19
5910-00-666-8475	7	18	6240-00-912-5186	24	2
5355-00-667-7900	13	7	5905-00-917-4149	23	5
5910-00-681-9264	2	19	5905-00-917-4149	25	11
5910-00-686-7110	11	2	5910-00-919-0161	10	4
5905-00-728-1659	25	6	5905-00-919-8613	7	31
5905-00-734-4083	25	13	5910-00-920-3776	11	4
5930-00-755-2005	18	11	5910-00-920-3776	11	8
5920-00-760-6324	3	17	5935-00-920-709s	3	24
5905-00-767-0944	21	4	5961-00-921-3778	24	28
6625-00-772-6119	13	8	5905-00-927-2876	10	30
5355-00-788-6925	3	24	5905-00-927-2876	24	22
5915-00-793-0226	18	4	5905-00-927-8485	22	4
5910-00-797-4909	22	2	5910-00-928-5344	10	3
5910-00-797-4909	23	2	5910-00-928-5344	11	11
5910-00-797-4909	24	15	5355-00-930-2692	13	29
5910-00-797-9731	7	6	5310-00-930-2722	14	14
5910-00-797-9731	18	4	5310-00-930-2722	15	15
5920-00-804-9688	22	22	5905-00-930-7956	24	3
5920-00-804-9688	23	25	5905-00-930-7959	10	29
5920-00-804-9688	23	25	5905-00-930-7959	10	29
5920-00-800-9688	24	5	5961-00-931-0286	26	1
5365-00-808-7384	14	21	5935-00-931-0420	3	1
5935-00-808-9569	22	19	5935-00-931-0420	14	27
5905-00-812-6400	21	6	5910-00-931-1908	3	18
5915-00-816-7231	10	8	5975-00-931-4820	16	8
5355-00-816-8372	13	1	5975-00-931-4820	17	14
5355-00-816-8373	13	2	5905-00-932-6822	19	4
5355-00-816-8374	13	27	5905-00-932-6822	26	12
5910-00-817-7275	11	14	5970-00-933-4602	16	4
6625-00-818-5973	13	13	5970-00-933-4602	17	11
4130-00-821-2447	5	4	5310-00-933-8120	4	8
5935-00-824-7685	17	8	5310-00-934-9759	4	1
5960-00-827-8782	2	21	5310-00-934-9760	4	4

**SECTION IV**

**TM11-6625-2520-24P**

**NATIONAL STOCK NUMBER AND PART NUMBER INDEX**

<b>STOCK NUMBER</b>	<b>FIGURE NO.</b>	<b>ITEM NO.</b>	<b>STOCK NUMBER</b>	<b>FIGURE NO.</b>	<b>ITEM NO.</b>
5310-00-934-9761	2	9	5305-00-958-5473	14	29
5310-00-934-9761	5	2	5910-00-959-5209	11	12
5310-00-934-976	7	19	5905-00-965-9049	25	1
5310-00-934-9761	18	7	5905-00-965-9051	23	6
5310-00-934-9761	23	23	5960-00-967-1083	2	5
5310-00-934-9765	7	5	5330-00-973-8288	16	6
5365-00-937-0638	13	20	5330-00-973-8288	17	13
5310-00-937-0650	16	7	5910-00-976-3080	10	1
5935-00-937-4421	16	5	5910-00-976-3080	11	1
5935-00-937-4421	17	12	5S61-00-978-7468	25	3
5961-00-938-5641	26	9	5905-00-982-0469	2	2
5310-00-939-0903	2	12	5905-00-984-7679	22	15
5310-00-935-0903	4	14	5905-00-s84-7679	23	1
5310-00-939-0903	7	4	5905-00-984-7679	1	1
5310-00-939-0903	7	21	5305-00-0 88-1603	18	44
5310-00-939-0903	14	9	5935-00-988-7758	8	3
5310-00-939-0903	15	8	5905-00-989-9546	23	[
5310-00-939-0903	18	12	5961-00-990-5369	25	9
5310-00-939-0903	23	22	5905-00-994-8531	19	8
5310-00-939-1063	14	23	5905-00-S94-6531	20	[
5310-00-942-5110	4	3	5905-00-994-8537	22	
5935-00-943-4072	7	12	5905-00-994-8537	25	4
5935-00-945-9824	26	5	S905-00-994-8544	26	3
5936-00-950-0537	10	6	5905-00-994-8545	22	9
5961-00-950-0537	22	3	5905-00-994-8548	19	9
5905-00-950-2798	2	31	5905-00-S94-8548	26	13
5305-00-957-6640	15	32	5905-0-994-85s50	19	26
5305-00-957-6645	13	12	5905-00-994-8553	24	26
5960-00-958-0073	26	4	6625-00-998-6521	14	18
5305-00-958-5453	18	14	6625-00-998-6522	14	18
5305-00-958-5473	13	10			

<b>PART NUMBER</b>	<b>FSCM</b>	<b>FIG. NO.</b>	<b>ITEM NO.</b>	<b>PART NUMBER</b>	<b>FSCM</b>	<b>FIG. NO.</b>	<b>ITEM NO.</b>
A1C	08108	22	21	MF7CD4643F	19701	19	6
ALC	08108	23	19	MF7CD4753F	19701	24	26
ALC	08108	24	2	MF7CD51R1F	19701	23	15
A3	06178	24	27	MF70DS620F	19701	9	3
BZ2RS	91929	18	10	MF7CD5622F	19701	23	8
CG756/URM	70903	2	1	MF7CD5622F	19701	24	10
CP07FA2	81349	18	3	MF7CD6192F	19701	10	28
CP54B1FF504K1	81349	7	40	MF70D8253F	19701	19	7
CP55B1EG254K1	81349	7	18	MF70D8253F	19701	23	13
C016B102E401J	56289	11	12	MF7CD8203F	19701	24	16
C32-4304J	16299	2	22	MS15795-806	96906	18	9
EAC301	82389	3	15	MS15795-806	96906	23	21
FP4-2402K	16299	26	1	MS15795-807	96906	2	11
FP4-3002K	16299	24	25	MS15795-807	96906	4	7
FPT-4702K	16299	24	18	MS1575-807	96906	4	15
FP1-7502K	16299	26	2	MS15795-807	96506	18	26
H16	81312	2	8	MS15795-942	96906	6	4
LP1-7-7502K	16299	24	24	MS16995-27	96906	18	44
MDX3	71400	3	16	MS35190-233	96506	13	12
MF7CD1003F	19701	24	3	MS35190-236	96906	18	14
MF7CD1004F	19701	19	8	MS35190-251	96906	13	10
MF7CD1004F	19701	20	1	MS35190-251	96S06	14	29
MF7CD1003F	19701	23	11	MS35190-259	96906	15	32
MF7CD1104F	19701	19	4	MS35199-10	96906	5	13
MF7CD0104F	19701	26	12	MS35333-106	96906	18	15
MF7CD1214F	19701	22	10	M555333-120	96906	13	31
MF7CD1303F	19701	24	19	MS35335-85	96906	14	23
MF7CD1303F	19701	25	12	MS35335-86	96906	2	12
MF7CD1304F	19701	22	13	MS35335-86	96906	4	14
MF7CD1304F	19701	24	21	MS35335-86	96906	7	4
MF7CD1503F	19701	22	8	MS35335-86	96906	7	21
MF7CD1503F	19701	25	4	M535335-86	96906	14	9
MF7CD1504F	19701	22	12	MS35335-86	96906	15	8
MF7CD1504F	19701	23	7	MS35335-86	96906	18	12
MF7CD1504F	19701	24	20	MS35335-86	96906	23	22
MF7CD2213F	19701	23	5	MS35335-87	96906	6	6
MF7CD2213F	19701	25	11	MS35335-87	96906	7	37
MF7CD2433F	19701	26	3	M535335-87	96906	13	11
MF7CD2743F	19701	22	9	M535335-87	96906	14	30
MF7CD3323F	19701	10	29	MS35335-87	96906	18	2
MF7CD3833F	19701	19	9	MS35335-88	96906	4	3
MF7CD3923F	19701	10	30	MS35336-56	96906	3	18
MF7CD3923F	19701	24	22	M535338-138	96906	4	8



## SECTION IV

## NATIONAL STOCK NUMBER AND PART NUMBER INDEX

TM11-6625-2520-24P

PART NUMBER	FSCM	FIG. NO.	ITEM NO.	PART NUMBER	FSCM	FIG. NO.	ITEM NO.
MS35338-40	96906	14	26	RCR32G682JS	81349	10	23
M535338-43	96906	3	5	RCR32G823JS	81349	10	27
MS35338-43	96906	4	17	RCR32G824JS	81349	22	14
M353038-98	96906	2	28	RCR42G103JS	81349	10	11
MS35338-98	96906	18	8	RCR42G103JS	81349	11	24
MS3533-98	96906	18	33	RCR42G183JS	81349	11	23
				RCR42G024JS	81349	23	9
MS35649-204	96906	4	4	RCR42G273JS	81349	11	19
M535649-264	96906	2	9	RCR42G333JS	81349	10	18
MS35649-264	96906	S	2	RCR42G333JS	81349	11	30
M535049-264	96906	7	19	RCR42G390JS	81349	23	4
MS35649-264	96906	18	1	RCR42G470JS	81349	24	1
MS35649-264	96906	23	20	RCR42G472JS	81349	21	4
MN35649-284	96906	4	18	RCR42G473JS	81349	11	16
MS35650-304	96906	7	5	RCR42G682JS	81349	21	3
M551795-806	96906	24	7	RN55C3482F	81349	2	2
MS51957-12	96906	14	22	RN55D1501F	81349	25	6
MS51957-14	96906	3	22	RN55D2001F	81349	23	16
MS51957-17	96906	14	25	RN55D2002F	81349	25	5
MS51S57-2	96906	13	30	RN55D2432F	81349	25	13
MS51957-28	96906	18	1	RN5504751F	81349	25	7
MS51957-34	96906	18	18	RN55D6811F	81349	25	14
MS51957-34	96906	18	28	RN60D1213F	81349	22	15
M551957-35	96906	18	34	RN60D1213F	81349	23	14
MS51957-37	96906	18	5U	RN60D1213F	81349	24	12
MS51957-38	96906	2	10	RN60D1211F	81349	22	
MS5L957-43	96906	6	5	RN6004753F	81349	22	5
MS51S57-43	96906	7	36	RN60D4753F	81349	23	10
MSS1957-43	96906	19	1	RN60D4753F	81349	24	14
MS51957-45	96906	3	4	RN60D6812F	81349	23	0
MS51957-66	96906	2	26	RN60D6812F	81349	24	23
M551958-27	96906	4	13	RN6006813F	81349	24	13
MS51958-27	96906	7	3	SG-756/JRM	80058	1	1
MS51958-28	96906	5	3	S1KDD7FS58115	86174	15	22
MS51958-28	96906	7	20	S3KDDFS58115	86174	15	23
MS51958-28	96906	4	8	TR	91929	18	11
MS51958-28	96906	18	51	0-443-4	06812	2	35
MS51958-30	96906	3	9	082	80131	2	23
M5S1958-30	96906	14	16	00618-00070	28480	4	16
MS51958-30	96906	23	20	00618-0041	28480	19	5
Ms51958-30	96906	24	6	00618-0049	28480	7	38
MS51960-65	96906	18	48	00618-0050	28480	4	
M14L1-4R3	16228	2	34	00618-0052	28480	7	Z
M7LS	81312	2	7	00618-0053	28480	4	1
M7P	81312	2	6	00618-0056	28480	4	5
M7S	81312	z	5	00618-020	24880	13	4
RC 32G474JS	81349	L01	6	00618-030	28480	4	10
RCR20G101JS	81349	7	16	006LB-031	28480	4	22
RCR20G474JS	81349	3	13	00618-034	28480	18	31
RCR32GJ72JS	81349	11	25	00618-204	28480	18	32
RCR32GI01JS	81349	11	34	00618-2046	28480	14	1
RCR32G103JS	81349	11	ZB	00618-2048	28480	2	33
RCR32G004JS	81349	10	20	00618-2056	28480	17	6
RCR32G010S4JS	81349	11	18	00618-2057	28480	26	8
RCR380L84JS	81349	21	5	00618-2059	28480	18	41
RCR32G150JS	81349	10	19	00618-2061	28480	18	40
RCR32G10SJS	81349	1	21	00618-226	28480	18	49
RCR32G122JS	81349	10	10	00618-231	28480	17	5
RCR32G122JS	81349	11	27	00618-238	28480	18	36
RCR32G124JS	81349	11	33	00618-6056	28480	5	1
RCR32G125JS	81349	10	24	00618-6060	28480	12	4
RCR32G125JS	81349	11	15	00618-6061	28480	12	3
RCR32G154JS	01349	10	12	00618-6062	28480	12	2
RCR32G154JS	81349	11	32	00618-6070	28480	3	19
RCR32G184JS	81349	10	21	00618-6071	28480	14	7
RCR32G272JS	81349	1	31	00618-6072	28480	8	30
RCR32G27JS	81349	11	31	00618-6075	28480	2	30
RCR32G274JS	81349	11	23	00618-6076	28480	12	1
RCR32G274JS	81349	18	13	00618-6077	28480	7	22
RCR32G274JS	81349	11	29	00618-6078	28480	7	30
RCR32G47JS	81349	22	6	00618-6079	28480	6	2
R0R32G473JS	81349	10	7	00618-6080	28480	14	84
R0R32G473JS	81349	11	17	00618-622	28480	24	14
R0R320474JS	81349	11	LTO	00618-624	28480	6	1
RCR32G01JS	81349	11	20	00618-628	28480	14	28
RCR32G562JS	81349	10	26	00618-632	28480	14	27
RCR32G564JS	81349	10	14	00618-640	28480	14	18
RCR32G681JS	81349	11	22	00618-643	28480	20	2

## SECTION IV

## NATIONAL STOCK NUMBER AND PART NUMBER INDEX

TM11-6625-2520-24P

PART NUMBER	FSCM	FIG. NO.	ITEM NO.	PART NUMBER	FSCM	FIG. NO.	ITEM NO.
00618-646	28480	14	5	1400-0008	28480	23	25
0140-0149	28480	11	2	1400-008	28480	24	5
0140-0157	28480	11	13	1410-003	28480	14	3
0140-0162	28480	10	4	1410-0009	28480	18	25
				1410-0033	28480	13	13
0140-0191	28480	11	9	1460-0048	28480	15	16
0140-0197	28480	11	3	1460-0048	28480	18	20
0140-0206	28480	10	3	148P22492	56289	11	14
0140-0209	28480	11	4	150-11-23-012	71785	7	11
0140-0209	28480	11	8				
0160-0088	28480	7	6	1510	88245	2	36
0160-0088	28480	18	4	1510	88245	4	21
0160-0102	28480	2	19	18000	73734	13	21
0160-2120	28480	10	1	1854-0003	28480	25	9
0160-2120	28480	11	1	1854-0221	28480	25	2
0160-2204	28480	10	5	1901-0025	28480	25	3
0160-2204	28480	11	6	1901-0026	28480	2	29
0160-2306	28480	10	2	1901-0026	28480	26	10
0160-2306	28480	11	10	1901-0029	28480	10	6
0160-3493	28480	11	5	1901-0029	28480	22	3
0180-0024	28480	3	11	1901-0036	28480	24	28
0180-0042	28480	3	12	1901-0096	28480	10	7
0180-0128	28480	3	18				
0370-0029	28480	13	9	1902-0241	28480	26	7
0370-0035	28480	13	3	1923-0071	28480	2	13
0370-0038	28480	13	22	1941-0005	28480	7	10
0370-0050	28480	13	14	1950-0004	28480	3	21
0380-0014	28480	18	35	2d754	03508	2	4
0380-0081	28480	14	19	2100-0025	28480	7	15
0380-0114	28480	25	10	2100-0028	28480	21	6
0403-0150	28480	4	11	2100-0029	28480	7	28
05-0730-02	91662	23	17	2100-0047	28480	7	32
05-0730-02	91662	24	9	2100-0047	28480	20	3
05-0930-02	91662	23	18	2100-0051	28480	7	34
05-0930-02	91662	24	17	2100-0059	28480	7	31
0811-0007	28480	22	11	2100-0127	28480	18	53
0812-0038	28480	22	16	2100-0308	28480	2	31
08614-227	28480	3	24	2100-0465	28480	20	5
1n3958	80131	23	3	2100-0898	28480	25	8
1n629	80131	26	9	2100-1472	28480	23	12
111-39-11-018	71785	7	7	2100-1472	28480	24	11
111-51-11-069	71785	22	20	2100-2154	28480	26	11
1120-1277	28480	14	1	2150	83330	18	13
113-34-12-026	71785	7	9	2190-0023	28480	2	17
11608	73734	4	2	2190-0496	28480	14	15
11608	73734	4	6	22028	73734	3	2
11608	73734	6	3	22042	73734	3	7
12AT7	80131	7	17	22044	56289	22	4
12AX7A	81349	2	21	243E2005	56289	22	4
12077	73734	4	9	29C214A3	56289	21	1
121-31-12-104	71785	7	12	29C214A3	56289	23	1
121-51-11-060	71785	22	19	30D206G050CC2	56289	7	35
1250-0005	28480	16	10	30GAS10	56289	26	6
1250-0005	28480	17	1	30GA510	56289	9	2
1250-0006	28480	16	2	3100-2089	28480	9	1
1250-0006	28480	17	7	3101-1248	28480	3	23
1250-0016	28480	13	20	312-500	75915	24	2
1250-0049	28480	8	2	313-500	75915	22	17
1250-0051	28480	8	1	313-500	75915	23	24
1250-0102	28480	8	3	3150-0005	28480	5	4
1250-0141	28480	16	1	33K5FS5115	86174	15	25
1250-0141	28480	17	4	332-14-07-183	71785	2	3
1250-0142	28480	16	8	332-14-07-183	71785	19	3
1250-0142	28480	17	14	342014	75915	3	17
1250-0143	28480	16	5	354-17-11-001	71785	21	1
1250-0143	28480	17	12	4233	73734	13	6
1250-0144	28480	17	8	4233	73734	18	56
1250-0145	28480	16	6	5GAS50	56289	22	2
1250-0145	28480	17	13	5GAS50	56289	23	2
1250-0146	28480	16	7	5GAS50	56289	24	15
1250-0147	28480	16	3	5000-0206	28480	15	15
1250-0147	28480	17	15	5000-0221	28480	21	7
1250-0148	28480	16	4	50000206	28480	14	14
1250-0148	28480	17	11	5020-0233	28480	15	1
1250-1026	28480	17	9	5020-0233	28480	18	23
1308	73734	2	27	5020-0234	28480	13	19
133-65-11-026	28400	11	11	5020-0256	28480	15	17
1400-0008	28480	22	22	5020-0278	28480	18	17

PART NUMBER	FSCM	FIG. NO.	ITEM NO.	PART NUMBER	FSCM	FIG. NO.	ITEM NO.
5020-0306	28480	3	1	618B36AA	28480	18	37
5020-0318	28480	14	4	618B36AD	28480	18	46
5020-0319	28480	14	2	6S1B36AE	28480	18	57
5020-0340	21480	18	27	618B36AJ	28480	18	6
5020-0349	28480	18	55	618B36AK	28480	18	39
5020-7433	28480	2	20	618B36AT	28480	18	5
5040-0214	28480	17	10	618B36AX	284e0	11	19
5040-0216	28480	13	29	618B36B0	28480	18	43
5040-0417	28480	22	18	618B360	28480	18	5
565IA	80131	2	14	618B36G	28410	18	50
6AL5	80131	7	8	618B36L	28480	18	24
6C4	80131	2	16	618B36N	28480	18	22
6EJ7EF184	80131	2	15	618B36P	28480	18	22
608D47J	28480	11	16	6I1836Q	28480	s1	29
61B3AT	28480	13	5	618B36R	28480	18	30
618408L	28480	13	24	618B36Z	28480	18	38
61B40B1	28480	13	7	61838	28480	2	18
61B40D4	28480	13	8	618B40A	28480	3	3
618B12E	28480	4	20	618B408	28480	13	26
618B16S	28480	7	25	618B400	28480	13	23
618B16T	28480	7	26	618540E	28480	13	25
618B16U	28480	7	23	618B40F	28480	13	1
618B16V	28480	7	24	61840G	28480	13	2
618827	28480	18	42	618B40H	28480	13	27
618B30	28480	13	16				
618B30	28480	14	10	618B47A	28480	15	6
618B3E	28480	13	15	618147C	28480	13	28
618B3F	28480	14	12	618B601	28480	10	8
618B3G	28480	14	11	618688A	28480	14	21
618B34AA	28480	14	17	6188120	28480	4	19
618B35	28480	14	6	61883A	28480	11	45
618B35A	28480	15	5	6189IW	81349	7	13
618B35D	28480	5	27	620A280	28480	18	47
618B35e	28480	15	9	6203688	28480	3	B
618B35G	28480	15	33	620A91A	28480	15	14
618B35H	28480	15	21	624B59C5	28480	15	10
618B35J	24a80	15	30	7120-1269	21840	13	18
618B35K	28480	15	31	7233	33173	2	24
618B35L	28480	15	19	78S45	02660	3	20
618B35M	28480	15	28	7895	81349	26	4
618B35N	28480	15	20	82100	73734	2	25
618B35PL	28480	15	11	88-28	91737	16	9
618B35PS	28480	15	12	88-28	91737	17	3
618B35Q	28480	15	18	88-35	91737	16	11
618B35R	28480	15	3	88-35	91737	17	2
618B35S	28480	15	29	9L00-2887	28480	3	14
618B35T	28480	15	2				
618B35U	28480	15	26	91-6006-5500-00	95354	20	4
618B35V	28480	15	24	91-60061500-00	95354	21	2
618B351	28480	15	4	9100-1703	28480	2	32

## NATIONAL STOCK NUMBER AND PART NUMBER INDEX

LATEST NATIONAL STOCK NUMBER ASSIGNMENTS

STOCK NUMBER	FIGURE NO..	ITEM NO.	NATIONAL STOCK NUMBER	FIGURE NO.	ITEM NO.
5910-00-07S-9238	7	11	5999-00-882-6993	8	7
5910-00-112-6968	7	29	5999-00-882-6993	8	10
5365-00-453-6650	8	5			
5365-00-453-6650	8	8	5935-00-918-4391	22	18
5365-00-453-6650	8	11	5935-00-988-7758	8	6
5355-00-816-8375	17	13	5935-00-988-7758	8	9
5961-00-821-2309	1	25	5935-00-988-7758	8	12
5960-00-860-7710	7	14			

LATEST PART NUMBER ASSIGNMENTS

PART NUMBER	FSCM	FIG. NO.	ITEM NO.	PART NUMBER	FSCM	FIG. NO.	ITEM NO.
JAN1N751A	81349	25	1	1250-0051	28480	8	7
MILL25	81349	7	29	1250-0051	28450	8	10
MILL5-18	81349	11	7	1250-0102	28480	8	6
MS355649-264	96906	24	8	1250-0102	8480	8	9
1250-0049	28480	8	5	1250-0102	28480	8	12
1250-0049	28480	8	8	618B40J	28480	13	17
1250-0049	28480	8	11	9SJ241	71785	7	14
1250-0051	28480	8	4				

ADDITIONAL LATEST STOCK NUMBER ASSIGNMENT

STOCK NUMBER	FIG. NO.	ITEM NO.
5910-00-666-5607	7	33

ADDITIONAL LATEST PART NUMBER ASSIGNMENT

PART NUMBER	FSCM	FIG
MILC25-5	8149	7

BY Order of the Secretary of the Army

BERNARD W. ROGERS  
*General, United States Army*  
*Chief of Staff*

Official:

PAUL T. SMITH  
*Major General, United States Army*  
*The Adjutant General*

Distribution:

*Active Army:*

USASA (2)  
DARCOM (1)  
OS Maj Comd (3)  
TECOM (2)  
USACC (5)  
USACC Sig Gp Okinawa (10)  
USACC Sig Gp Taiwan (10)  
USACC-PAC (2)  
Eighth USA (3)  
I Corps (2)  
USAICS (3)  
USASIGS (5)  
HISA (Ft Monmouth (3)

USA Dep (PAC) (2)  
Depots (1) except  
SAAD (20)  
TOAD (14)  
LBAD (5)  
MAAG, Republic of China (2)  
USACSA (3)  
Sig FLDMS (PAC) (1)  
JUSMAG, Korea (1)  
USA Camp Carroll Dep (2)  
Units org under fol TOE:  
(1 cy each fol unit)  
11-302  
29-134  
29-136

NG: None

USAR: None

For explanation of abbreviation used, see AR 310-50

(30368)

\*U.S. GOVERNMENT PRINTING OFFICE: 1990 -262-912

RECOMMENDED CHANGES TO EQUIPMENT TECHNICAL PUBLICATIONS



THEN... JOT DOWN THE DOPE ABOUT IT ON THIS FORM. CAREFULLY TEAR IT OUT. FOLD IT AND DROP IT IN THE MAIL!

**SOMETHING WRONG WITH THIS PUBLICATION?**

FROM: (PRINT YOUR UNIT'S COMPLETE ADDRESS)

DATE SENT

PUBLICATION NUMBER

TM 11-5825-270-10

PUBLICATION DATE

23 Jul 81

PUBLICATION TITLE

Radio Frequency R-2176/FRN

BE EXACT... PIN-POINT WHERE IT IS

PAGE NO.	PARA-GRAPH	FIGURE NO.	TABLE NO.

IN THIS SPACE TELL WHAT IS WRONG AND WHAT SHOULD BE DONE ABOUT IT:

TEAR ALONG PREPARED LINE

PRINTED NAME, GRADE OR TITLE, AND TELEPHONE NUMBER

SIGN HERE:

DA FORM 2028-2  
JUL 79

PREVIOUS EDITIONS ARE OBSOLETE.

P.S.—IF YOUR OUTFIT WANTS TO KNOW ABOUT YOUR RECOMMENDATION MAKE A CARBON COPY OF THIS AND GIVE IT TO YOUR HEADQUARTERS.

